



38 Monks Haven

Stanford-Le-Hope, Stanford-Le-Hope

Welcome to your dream home, a meticulously crafted oasis of comfort and elegance. Nestled in an ideal location for families, this exquisite 3-bedroom semi-detached house presents itself as the epitome of luxurious living.

As you step through the front door of this wonderful extended family home, you are greeted with an air of sophistication and charm. The spacious open-plan living room and dining area beckon you to unwind in style, offering a seamless transition from relaxation to entertainment. The natural light floods in, accentuating the newly fitted modern kitchen, a culinary masterpiece waiting to be explored. Integrated kitchen appliances promise convenience and functionality, elevating your cooking experience to new heights.

Three generously proportioned bedrooms provide ample space for rest and rejuvenation, each boasting its own unique charm. The modern bathroom suite, adorned with contemporary fixtures, offers a tranquil sanctuary for moments of self-indulgence.

Situated on a great size corner plot, this home exudes a sense of privacy and exclusivity. With the potential to extend (subject to planning permission), this property offers endless possibilities to tailor the space to suit your lifestyle. The well-maintained rear and front gardens invite you to bask in the tranquillity of nature, creating a serene backdrop for relaxation and outdoor activities. Off-road parking and a garage ensure that practicality meets luxury, providing convenience and security for you and your family.

- Wonderful Extended Family Home
- Ideal Location for Families
- Walking Distance to Amenities & Transport Links



Hallway

13' 1" x 5' 10" (3.98m x 1.79m)

Living/ Dining Room

26' 4" x 12' 4" (8.03m x 3.77m)

Kitchen

9' 11" x 9' 0" (3.03m x 2.74m)

Utility/ Extension

11' 3" x 7' 4" (3.43m x 2.24m)

Landing

9' 9" x 7' 4" (2.98m x 2.23m)

Bedroom 1

12' 8" x 11' 1" (3.86m x 3.38m)

Bedroom 2

11' 1" x 10' 0" (3.39m x 3.05m)

Bedroom 3

7' 4" x 7' 0" (2.23m x 2.14m)

Bathroom

7' 4" x 5' 7" (2.23m x 1.70m)



GROUND FLOOR



1ST FLOOR

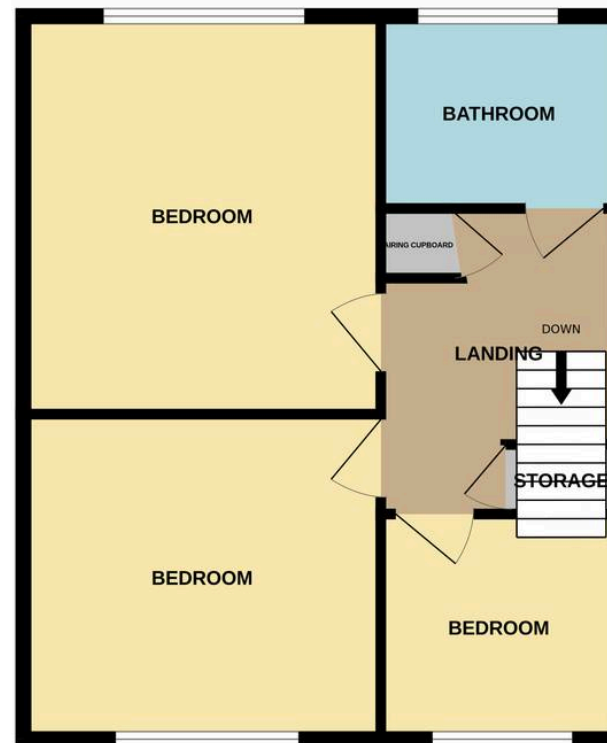

Whilst every attempt has been made to ensure the accuracy of the floorplan contained here, measurements of doors, windows, rooms and any other items are approximate and no responsibility is taken for any error, omission or mis-statement. This plan is for illustrative purposes only and should be used as such by any prospective purchaser. The services, systems and appliances shown have not been tested and no guarantee as to their operability or efficiency can be given.
Made with Metropix ©2025