



Poise Close, Hazel Grove, Stockport SK7 4NY

Guide Price £375,000

🛏 4 🚿 2 🚗 1



SUMMARY:

Much improved and attractively presented FOUR BED, TWO BATH c1950's semi-detached enjoying peaceful cul-de-sac location off Torkington Road; close to Torkington Park and Torkington Primary School. Minutes walk from village centre and railway station and 5 minutes drive to SEMMMs link road. GFCH, double glazing, CWI. Briefly comprises, to the ground floor, porch, hall, sitting room, refitted dining kitchen with integrated appliances, first floor landing, three bedrooms (one fitted) and refitted shower/wc, and second floor of 17' master bedroom with en-suite shower/wc. Good size plot with lean-to garage, a well enclosed rear garden and a gated driveway and small garden to the front.



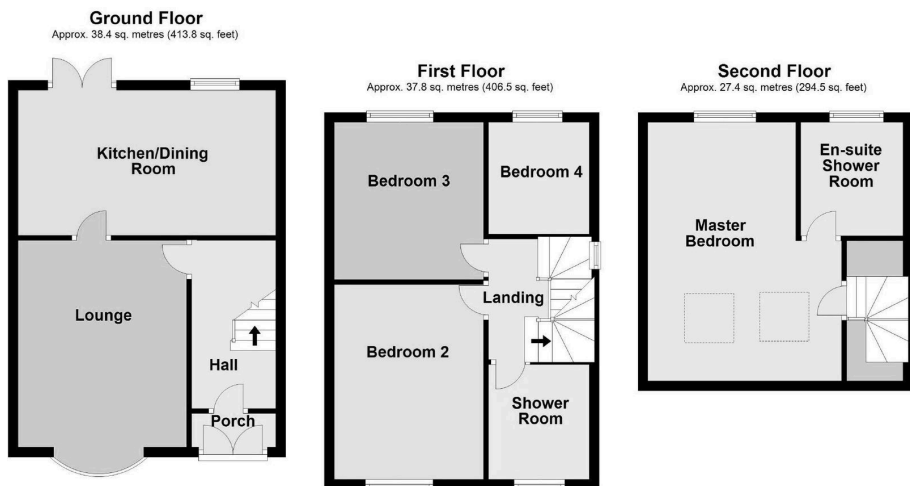

Total area: approx. 103.6 sq. metres (1114.8 sq. feet)

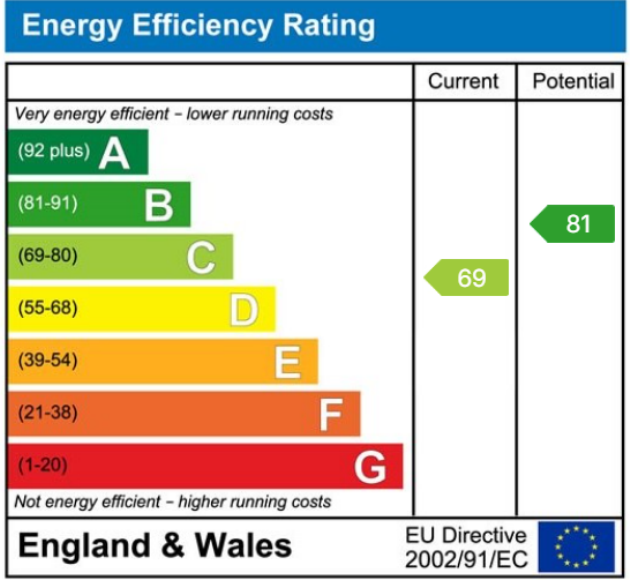

184 London Road, Hazel Grove, Stockport, Cheshire SK7 4DQ
T: 0161 483 5100 E: sales@woodhallproperties.co.uk W: www.woodhallproperties.co.uk