



1 WINGATE WALK

AYLESBURY, HP20 1LN

£325,000
FREEHOLD

A three bedroom end of terrace house set on the southside of Aylesbury and within catchment to desirable schools. Offered with no upper chain and in need of some modernisation, accommodation offers front and rear gardens, kitchen/breakfast room, living room, three bedrooms and bathroom.



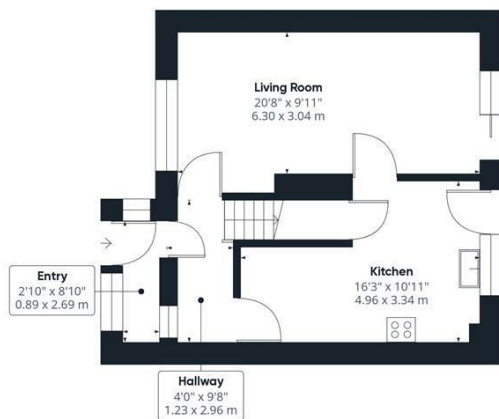

Ground Floor



Floor 1

Approximate total area[†]
851.64 ft²
79.12 m²

(†) Excluding balconies and terraces

While every attempt has been made to ensure accuracy, all measurements are approximate, not to scale. This floor plan is for illustrative purposes only.

Calculations are based on RICS IPMS 3C standard.

GIRAFFE360

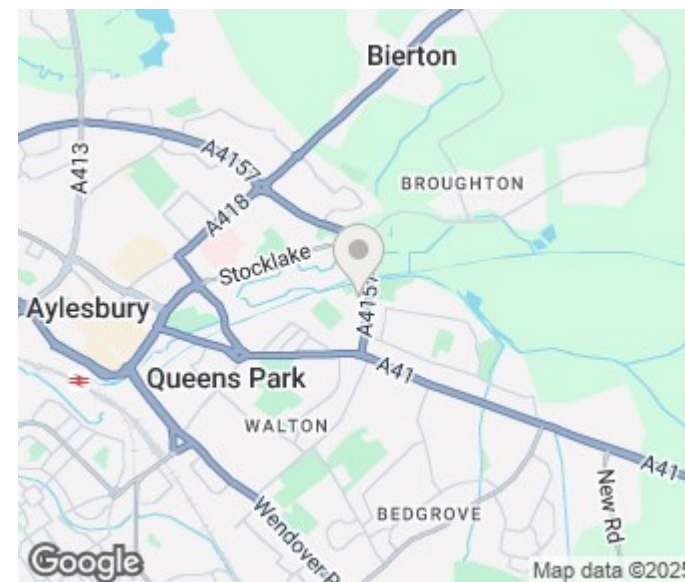

Energy Efficiency Rating		
	Current	Potential
Very energy efficient - lower running costs		
(92 plus) A		
(81-91) B		
(69-80) C		
(55-68) D		
(39-54) E		
(21-38) F		
(1-20) G		
Not energy efficient - higher running costs		
England & Wales	EU Directive 2002/91/EC	

Agents Note: Whilst every care has been taken to prepare these particulars, they are for guidance purposes only. All measurements are approximate and are for general guidance purposes only and whilst every care has been taken to ensure their accuracy, they should not be relied upon and potential buyers/tenants are advised to recheck the measurements

George David & Co
46 High Street
Aylesbury
HP20 1SE

01296 393 393
info@georgedavid.co.uk
www.georgedavid.co.uk

