



1 WYKEHAM PATH

AYLESBURY, HP19 9RW

£550,000
FREEHOLD

A five bed detached family home that OVERLOOKS OPEN FIELDS on the ever popular Buckingham Park Estate. The property benefits from: Three bathrooms - Four of five bedrooms are doubles - Garage with parking space and two vehicle car port - Kitchen with fitted appliances - NO UPPER CHAIN.





Ground Floor Building 1



Floor 1 Building 1

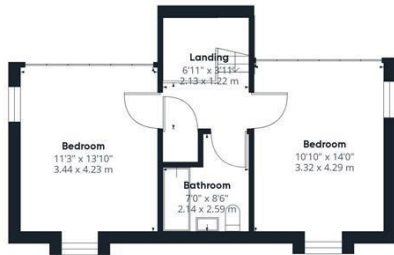

Floor 2 Building 1



Ground Floor Building 2

Approximate total area[®]
1755.16 ft²
163.06 m²

Reduced headroom
0.56 ft²
0.05 m²

(1) Excluding balconies and terraces

Reduced headroom
Below 5 ft/1.5 m

While every attempt has been made to ensure accuracy, all measurements are approximate, not to scale. This floor plan is for illustrative purposes only.

Calculations are based on RICS IPMS 3C standard.

GIRAFFE360

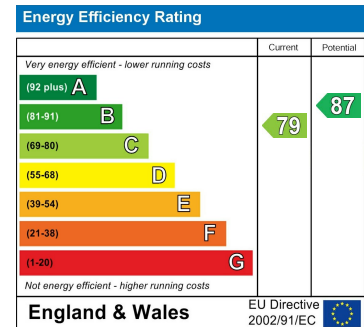
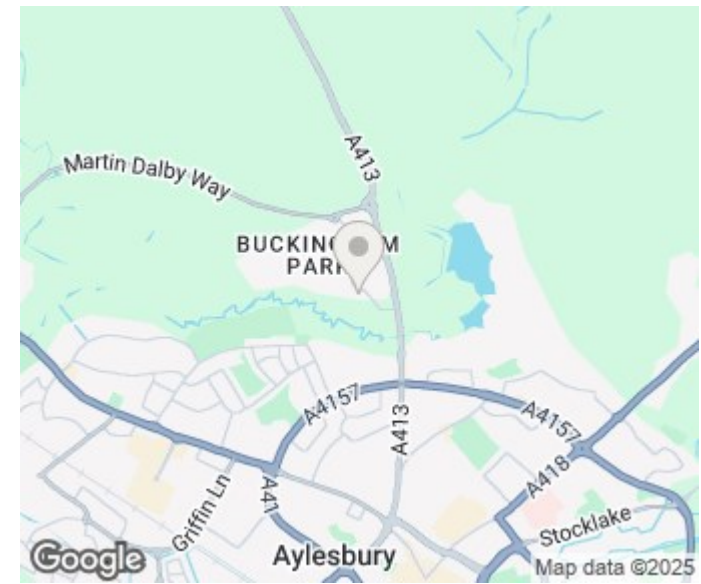

Agents Note: Whilst every care has been taken to prepare these particulars, they are for guidance purposes only. All measurements are approximate and are for general guidance purposes only and whilst every care has been taken to ensure their accuracy, they should not be relied upon and potential buyers/tenants are advised to recheck the measurements

George David & Co
46 High Street
Aylesbury
HP20 1SE

01296 393 393
info@georgedavid.co.uk
www.georgedavid.co.uk

