



## FLAT 11, 15 FORBES PLACE, PAISLEY. PA1 1UT.

THIS CONVERTED TWO BEDROOM ATTIC FLAT IS SITUATED IN A REFURBISHED GRADE 'B' LISTED BUILDING BEING OF ARCHITECTURAL AND HISTORIC INTEREST AND CONTAINED WITHIN THE PAISLEY TOWN CENTRE CONSERVATION AREA. CLOSE TO ALL LOCAL AMENITIES AND TRANSPORT LINKS. THE FLAT ITSELF IS IN GOOD ORDER INTERNALLY WITH BRIGHT, FRESH DECOR AND PRESENTING STUNNING VIEWS OVER THE HISTORICAL PAISLEY ABBEY. FURTHER BENEFITS INCLUDE SECURITY ENTRY SYSTEM. COMMUNAL REAR GARDEN. ON STREET PARKING / POSSIBLE PARKING PERMIT. FRESHLY DECORATED THROUGHOUT. IDEAL FIRST TIME PURCHASE OR BUY TO LET.



- 2 BEDROOM ATTIC FLAT
- CONSERVATION AREA
- TOWN CENTRE LOCATION
- DOUBLE GLAZING
- GRADE 'B' LISTED BUILDING
- SECURE DOOR ENTRY
- ON STREET PARKING / POSSIBLE PERMIT
- COMMUNAL REAR AREA

**OFFERS IN THE REGION OF £75,000**

# FLAT 11, 15 FORBES PLACE, PAISLEY. PA1 1UT.

## OFFERS IN THE REGION OF £75,000

### ENTRANCE HALL

ENTRANCE HALL GIVES ACCESS TO ALL ROOMS. FRESHLY DECORATED. STORAGE CUPBOARD HOUSING METERS. OAK EFFECT LAMINATE FLOORING.

### LOUNGE 17' 3" x 14' 4" (5.26M x 4.37M)

SPACIOUS LOUNGE WITH VELUX WINDOWS FACING BOTH OVER THE ABBEY AND TOWARDS THE TOWN CENTRE. AMPLE SPACE FOR DINING TABLE AND CHAIRS. FRESH DECOR. OAK EFFECT LAMINATE FLOORING.

### KITCHEN 9' 10" x 8' 2" (2.99M x 2.49M)

FITTED KITCHEN WITH AMPLE STORAGE UNITS, BUTCHER BLOCK WORK SURFACE AND SPLASHBACK. ELECTRIC FAN OVEN AND HOB. UNDERCOUNTER FRIDGE AND FREEZER. WASHING MACHINE. VELUX WINDOW.

### BEDROOM 1 18' 2" x 8' 4" (5.53M x 2.53M)

GOOD SIZE DOUBLE BEDROOM FRESHLY DECORATED. MIRRORED SLIDING DOOR STORAGE CUPBOARD / WARDROBE. VELUX WINDOW. OAK EFFECT LAMINATE FLOORING.

### BEDROOM 2 11' 7" x 10' 2" (3.52M x 3.11M)

BEDROOM 2 AGAIN GOOD SIZE WITH FRESH DECOR AND VELUX WINDOW.

### SHOWER ROOM 7' 6" x 6' 6" (2.29M x 1.99M)

TWO PIECE GREY SUITE AND STANDALONE SHOWER CUBICLE WITH ELECTRIC SHOWER. WALL TILING TO HALF HEIGHT. SMALL STORAGE CUPBOARD.

### VIEWS OVER PAISLEY ABBEY

BEAUTIFUL VIEWS OF PAISLEY ABBEY AND GROUNDS.



GROUND FLOOR

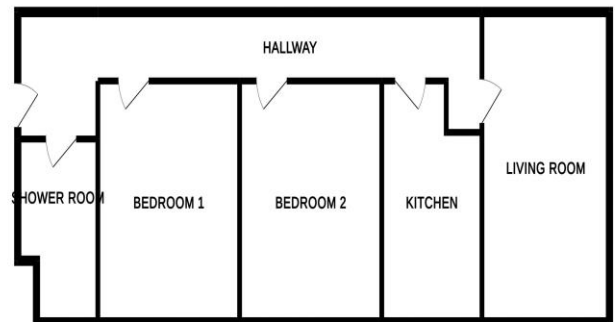

Whilst every attempt has been made to ensure the accuracy of the floorplan contained herein, measurements of all doors, windows, rooms and any other items are approximate and no responsibility is taken for any error, omission or misstatement. This plan is for illustrative purposes only and should be used as such by any prospective purchaser. The services, systems and appliances shown have not been tested and no guarantee is given as to their operability or efficiency at the time of the plan.  
Made with Metropix ©2020

As a regulated business we are required to comply with the "The Money Laundering, Terrorist Financing and Transfer Funds (Information on the Payer) Regulations 2017. Intending purchasers will be asked to produce documentation to satisfy these requirements on acceptance of a formal offer. These will include proof of identification, proof of address and proof of funds to facilitate the purchase including deposit and any loan funds. Your cooperation in this is greatly appreciated.

DISCLAIMER - WHILST WE ENDEAVOR TO MAKE THESE PARTICULARS AS ACCURATE AS POSSIBLE, THEY DO NOT FORM PART OF ANY CONTRACT OR OFFER, NOR ARE THEY GUARANTEED. MEASUREMENTS ARE APPROXIMATE AND IN MOST CASES ARE TAKEN WITH A DIGITAL/SONIC MEASURING DEVICE AND ARE TAKEN AT THE WIDEST POINT. WE HAVE NOT TESTED THE ELECTRICITY, GAS OR WATER SERVICES OR ANY APPLIANCES. PHOTOGRAPHS ARE REPRODUCED FOR GENERAL INFORMATION AND IT MUST NOT BE INFERRED THAT ANY ITEM IS INCLUDED FOR SALE WITH THE PROPERTY. IF THERE IS ANY PART OF THIS THAT YOU FIND MISLEADING OR SIMPLY WISH CLARIFICATION ON ANY POINT, PLEASE CONTACT OUR OFFICE IMMEDIATELY WHEN WE WILL ENDEAVOR TO ASSIST YOU IN ANY WAY POSSIBLE



**OFFERS IN THE REGION OF £75,000**