

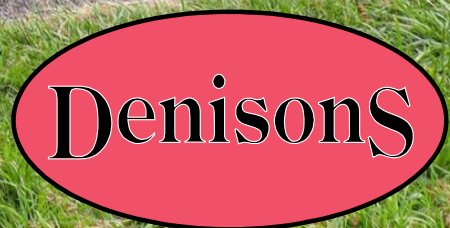

26 Redcliffe Close





# 26 Redcliffe Close

Burton, BH23 7NA

£270,000

This three bedroom mid terrace house is an ideal property for first time buyers or investors.

Situated in the peaceful village of burton the property benefits from being located in the local schools catchment area.

The internal accommodation comprises of a spacious living area, open-plan kitchen/diner, three great sized bedrooms and a wet room.

Externally there is a private rear garden, a low maintenance front garden, off-road parking and a garage.

The property is in need of modernisation and is offered with no forward chain. An internal viewing is strongly advised.





**Porch**

**Kitchen/Diner 14' 9" x 14' 2" (4.49m x 4.31m)**

**Lounge 10' 10" x 14' 2" (3.30m x 4.31m)**

**Bedroom 1 8' 11" x 14' 2" (2.72m x 4.31m)**

**Bedroom 2 10' 6" x 7' 8" (3.20m x 2.34m)**

**Bedroom 3 7' 8" x 7' 3" (2.34m x 2.21m)**

**Wet Room**

**Garage**

**Off Road Parking**



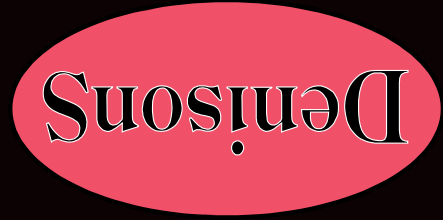
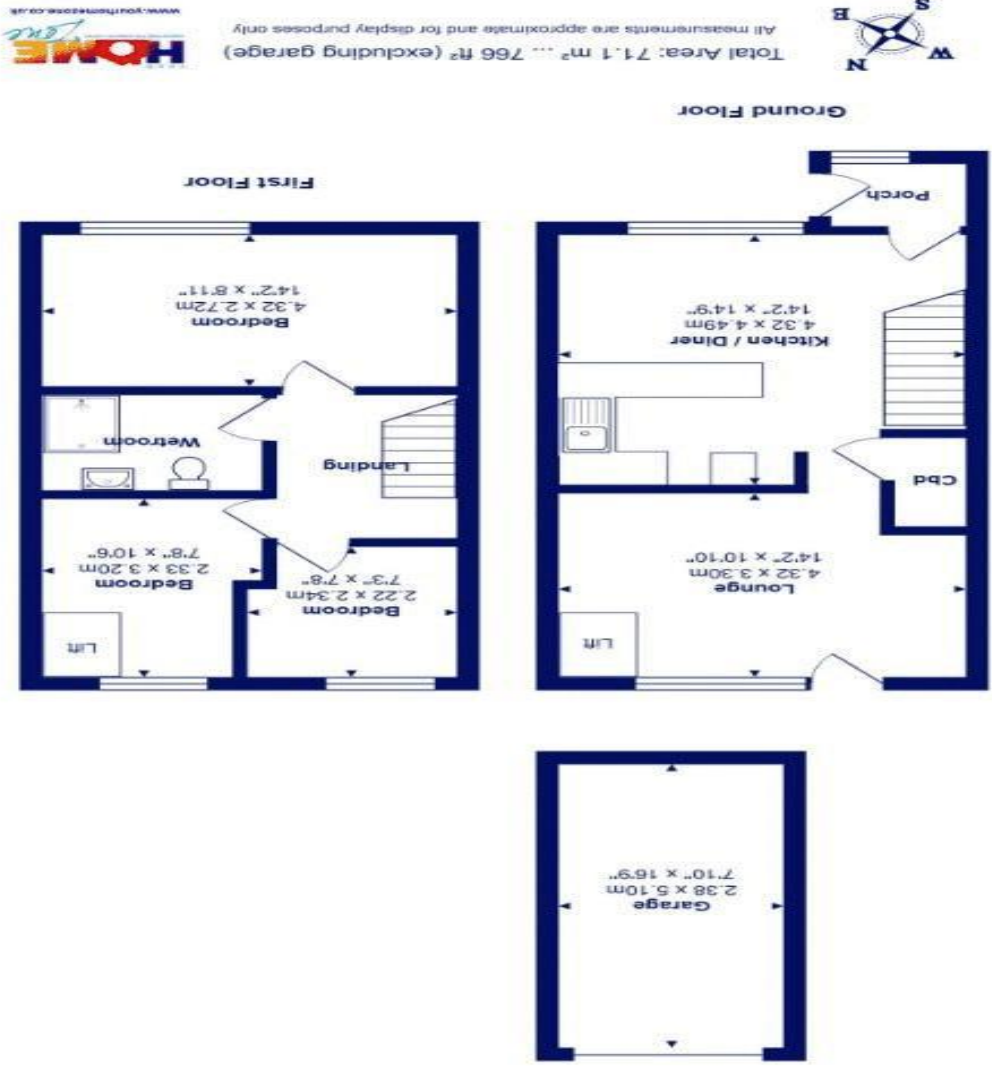

Christchurch  
12 Castle Street, Christchurch BH23 1DT  
01202 484748  
christchurch@denisons.com

Mayfair  
Cashel House, London, W1U 3JT  
0870 112 7099  
mayfair@denisons.com  
www.denisons.com

Denisons for themselves and for the Vendors or lessors of this property, whose Agents they are, give notice that these particulars are produced in good faith, are set out as a general guide only and do not constitute any part of a Contract. No person in the employment of Denisons has any authority to make or give any representation or warranty whatever in relation to this property.