



21 Millhams Street

DenisonS

21 Millhams Street

Christchurch, Dorset, BH23 1DN,

£325,000

This **TWO BEDROOM CHARACTER COTTAGE** IS SITUATED IN THE HEART OF CHRISTCHURCH TOWN CENTRE and would make an ideal investment property or lock up and leave holiday home. The internal accommodation comprises of a spacious lounge, kitchen, **TWO DOUBLE BEDROOMS** and a family shower room. Externally there is a **COURTYARD GARDEN** with an added bonus of the only property benefitting from off road parking space. This property is a stone's throw away from the Christchurch high street, beautiful river walks along the banks of the Stour and the historic eleventh century Priory. The property further benefits from **NO ONWARD CHAIN**. We strongly recommend a full internal viewing to fully appreciate the extent of accommodation on offer. **EPC & FLOORPLAN TO FOLLOW.**



Lounge 9' 10" x 12' 11" (2.99m x 3.93m)

Dining Area 8' 2" x 12' 11" (2.49m x 3.93m)

Shower Room

Kitchen 11' 11" x 6' 10" (3.63m x 2.08m)

Bedroom 1 9' 9" x 12' 10" (2.97m x 3.91m)

Bedroom 8' 1" x 10' 4" (2.46m x 3.15m)



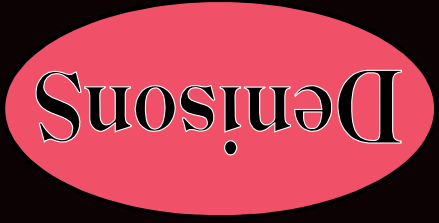

Denisons for themselves and for the Vendors or lessors of this property, whose Agents they are, give notice that these particulars are produced in good faith, are set out as a general guide only and do not constitute any part of a Contract. No person in the employment of Denisons has any authority to make or give any representation or warranty whatever in relation to this property.

www.denisons.com

Mayfair
Cashel House, London, W1U 3JT
0870 112 7099
mayfair@denisons.com

Christchurch
12 Castle Street, Christchurch BH23 1DT
01202 484748
christchurch@denisons.com



All measurements are approximate and for display purposes only

Total Area: 57.7 m² ... 621 ft²

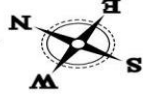

First Floor

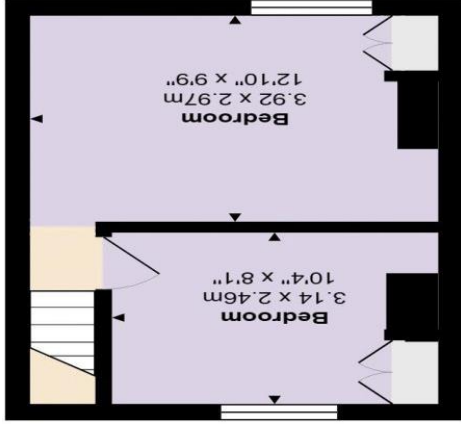

Ground Floor

