



Manor Gardens, N7

£400,000

Set within the architecturally acclaimed Beaux Arts Building, this one bedroom flat has gone through a stunning renovation and offers a fitted kitchen, a spacious reception room and access to communal gardens and a roof terrace.

A unique opportunity to live in one of Islington's most sought after communal residences. The Beaux Arts Building is close to excellent public transport links, including Holloway Road, Finsbury Park and Archway underground stations.

Features

- Share of Freehold
- Private Gym
- Communal Gardens
- 24-Hour Concierge
- Shared Rooftop Terraces
- Great Transport Links

Manor Gardens, London, N7

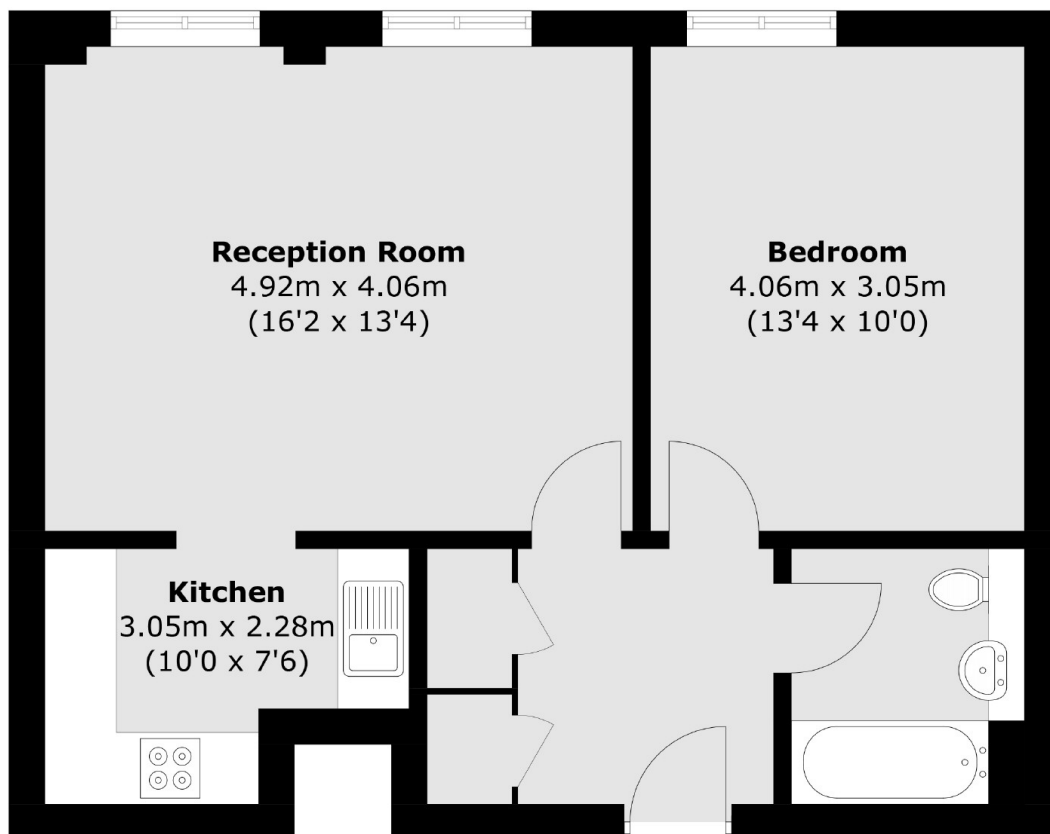

Total area (approx.): 51.1 sq. m (550.0 sq. ft)