



Yerbury Road, N19

£1,750,000

A charming six bedroom house in one of the best locations in Tufnell Park. This property has high-ceilings, feature fireplaces, character throughout and is in the Yerbury School catchment area.

Yerbury Road is ideally located for easy access to Tufnell Park station (Northern line), Upper Holloway (Overground) and the diverse array of boutique shops and restaurants on Fortess Road.

Features

- Yerbury School Catchment
- Separate Annex
- Six Bedrooms
- Private Garden
- Open Plan Kitchen/Diner
- Good Transport Links



Yerbury Road, N19

As you enter the property on the ground floor, to the right is the large kitchen/dining room area, which opens out onto a private garden. Beyond the garden, there is a separate annex, currently used as a rental unit, offering additional income potential. Also located on the ground floor is a separate reception room featuring a charming fireplace.

The first floor has three spacious double bedrooms, with the largest bedroom enjoying an abundance of natural light thanks to its two bay windows. On the second floor there are two additional bedrooms, both of which benefit from en suite bathrooms,



Yerbury Road, London, N19

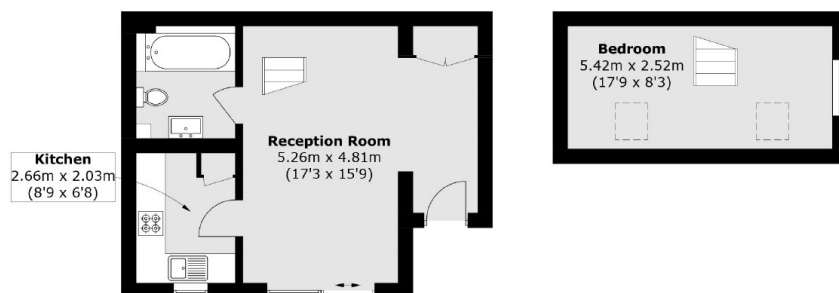

Total area (approx.) 192.4 sq. m (2,070.9 sq. ft)
(Excluding Eaves)
Outbuilding: 48.5 sq. m (523.1 sq. ft)

Dexters

Dartmouth Park & Tufnell Park
64 Chetwynd Road
Dartmouth Park
London
Sales
020 7284 0101

Energy Rating: E. We aim to make our particulars both accurate and reliable. However they are not guaranteed; nor do they form part of an offer or contract. If you require clarification on any points then please contact us, especially if you're traveling some distance to view. Please note that appliances and heating systems have not been tested and therefore no warranties can be given as to their good working order.

RICS Regulated Estate Agent and Letting Agent

dexters.co.uk