

## Hornsey Road, N19

### £300,000

A recently renovated one bedroom apartment set on the ground floor of a period terraced building. This property offers open plan living, good storage and a private outside space.

Hornsey Road is within close proximity to local parks and excellent transport links including Finsbury Park station (Piccadilly & Victoria lines, National Rail & Thameslink services) and Archway station (Northern line).

### Features

- One Double Bedroom
- Great Transport Links
- Chain Free
- Private Patio Garden
- Ground Floor
- Recently Renovated

# Hornsey Road, London, N19

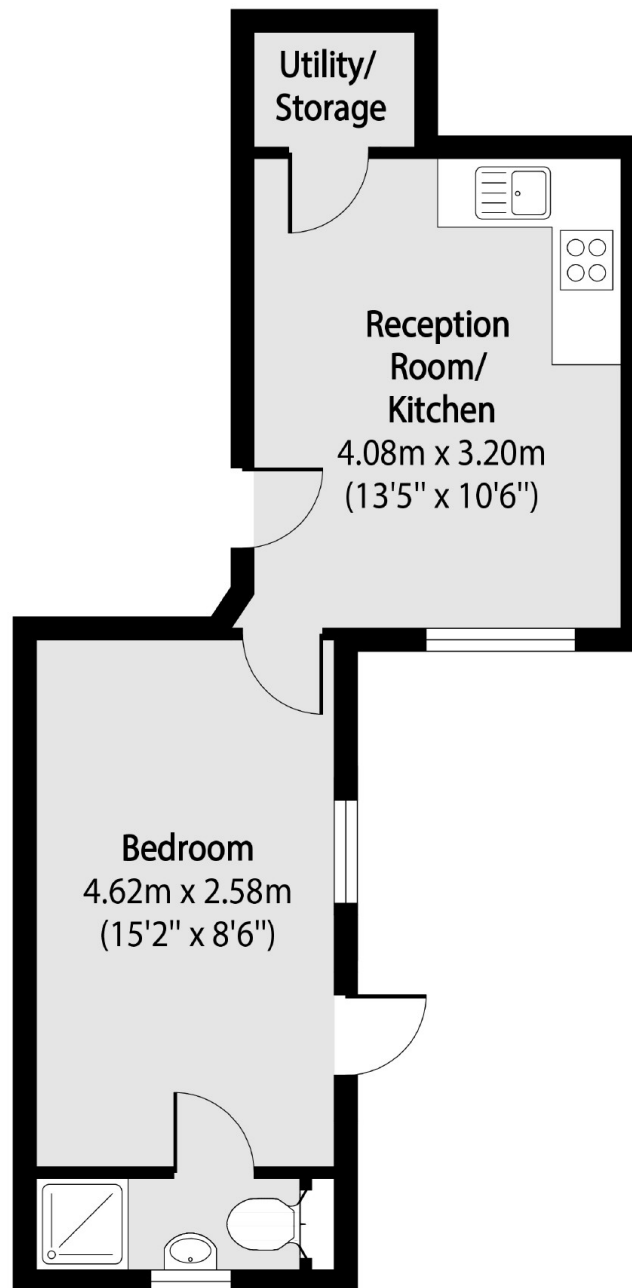

Total area (approx): 29.08 sq m (313 sq. ft)