



Brecknock Road, N7

£1,100,000

Located in the highly sought after area between Kentish Town and Tufnell Park, a three bedroom semi-detached Victorian house, with a south west facing patio.

Brecknock Road features a diverse selection of local shops, and is still within easy reach of the transport facilities of Kentish Town (Northern line & Thameslink), with cosmopolitan Camden Town just beyond.

Features

- Freehold House
- Three Double Bedrooms
- Semi Detached
- Southwest Facing Patio
- Chain Free
- Renovation Required



Brecknock Road, N7

This charming house features raised ground floor access with a separate reception room and living room, both retaining classic period features including original fireplaces.

The lower ground floor offers an open plan kitchen and living area with direct access to a south west facing patio, and a rear bedroom. On the first floor, you'll find two spacious double bedrooms and a loft space.



Brecknock Road, London, N7

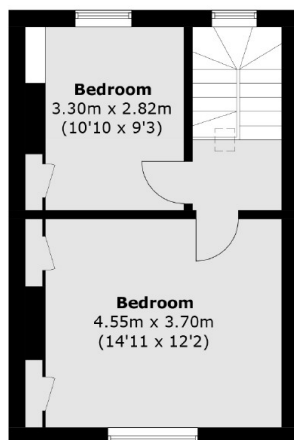

First Floor

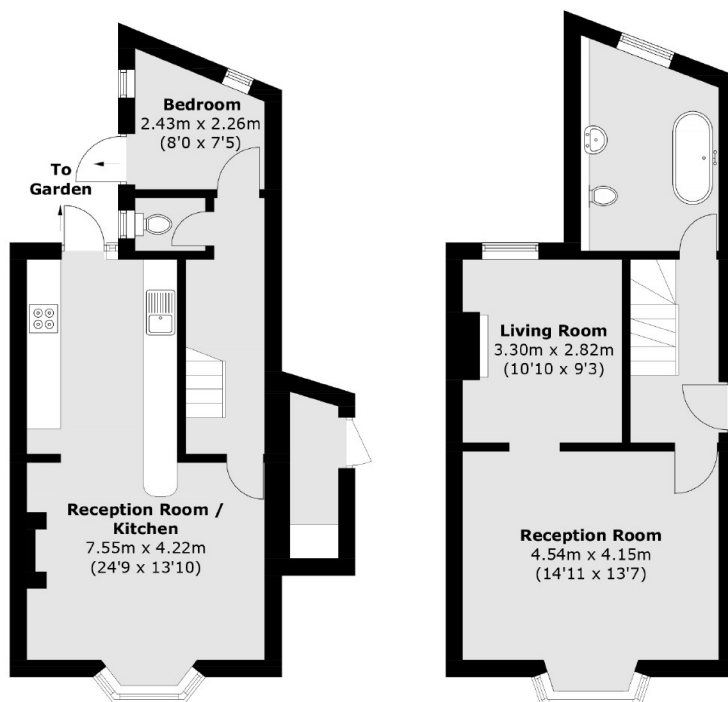

Basement

Ground Floor

Approx Internal Area: 112.3 sq. m (1,208.7 sq. ft)
(Including Basement)
External Cupboard : 2.5 sq. m (26.9 sq. ft)
Total: 114.8 sq. m (1,235.6 sq. ft)