



Kingswear Road, NW5

£800,000

This ground floor flat offers four double bedrooms, a separate kitchen and a large reception room. The property is set back from the road and provides a split-level, private patio and garden.

Located in the heart of the Dartmouth Park Conservation Area, and only a short walk from Hampstead Heath, Highgate Village and the charming independent shops and cafés on Swains Lane

Features

- Ground Floor Flat
- Four Double Bedrooms
- Separate Kitchen
- Rear and Front Garden
- Chain-Free
- Conservation Area



Kingswear Road, NW5

On the left is the first bedroom, currently being used as a study, providing ample storage space. Behind this bedroom is a store cupboard, offering further storage space, and there is another double bedroom to the rear of the property, along with a well-presented family bathroom.

Down the carpeted hallway is the large reception room, which faces the front of the property, providing maximum light. The separate kitchen is the other side of the hallway, backing on to the patio, with steps to the large, private garden.

At the end of the hallway are two further double bedrooms, both with cornicing, and one with panelling across the ceiling.



Kingswear Road, London, NW5

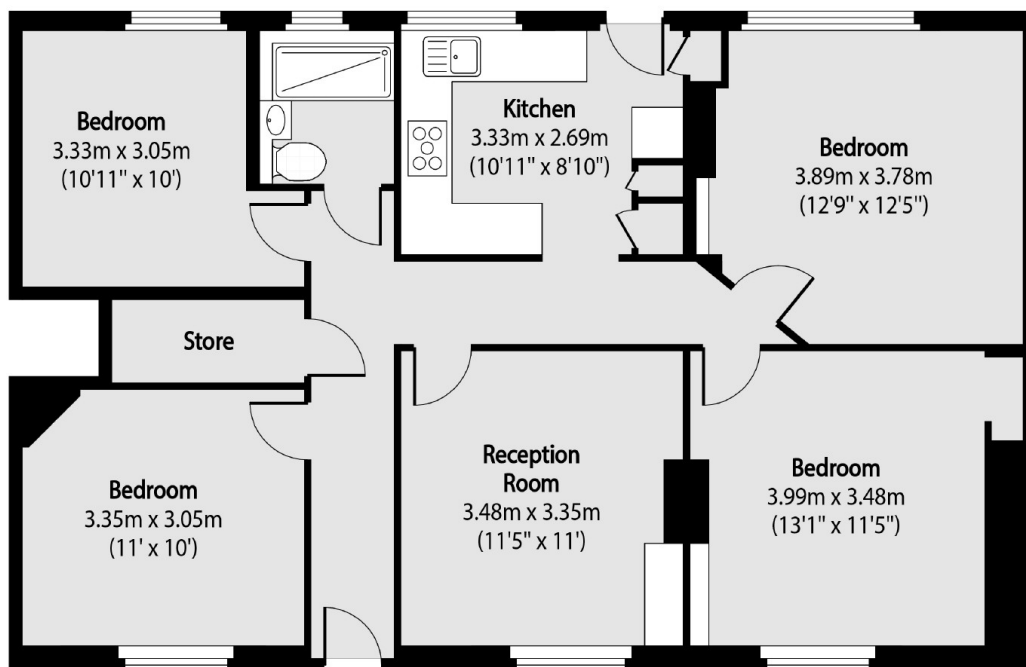
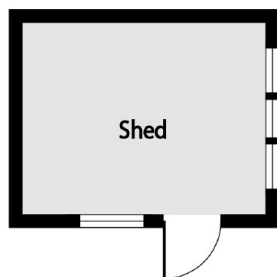

Total area (approx): 84.45 sq m (909 sq. ft)

Shed total area (approx): 6.60 sq m (71 sq. ft)