

## Whewell Road, N19

£495,000

A well-presented Ground floor flat within a Victorian conversion. This property has two double bedrooms, an open plan reception room/kitchen with large windows allowing for lots of natural light and a secluded garden.

Whewell Road is located just off one of the most vibrant high streets in North London, offering a wide array of shops, cafés and restaurants. Holloway Road and Archway stations are also close by.

### Features

- Share of Freehold
- Chain-Free
- Open Plan Living
- Two Double Bedrooms
- Period Conversion
- Private Garden

# Whewell Road, London, N19

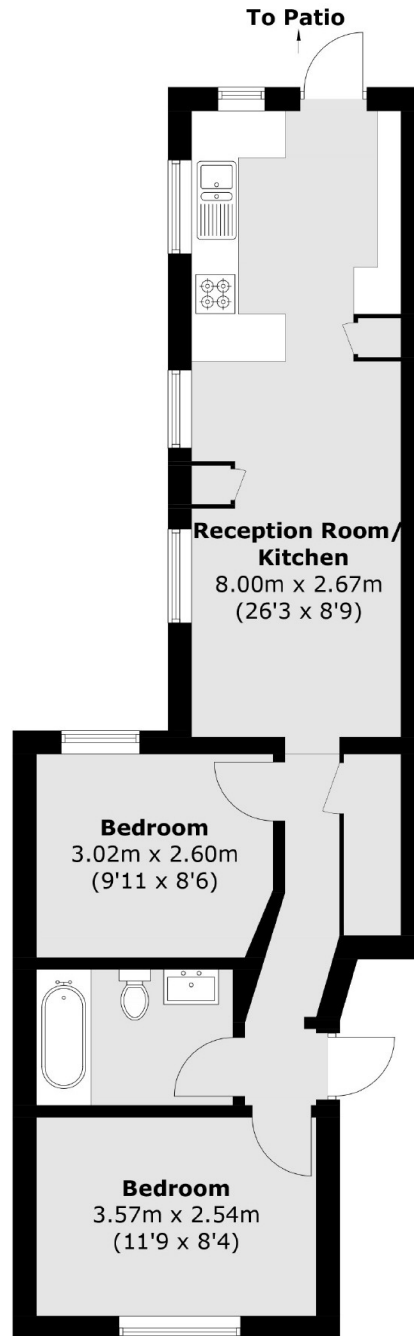

Total area (approx.): 50.5 sq. m (543.6 sq. ft)