



Tollington Way, N7

£650,000

A spacious two bedroom ground floor flat set within a Victorian conversion. The property has a large open plan reception room/kitchen with a feature fireplace, and a secluded garden, accessible from both bedrooms.

Tollington Way is a quiet residential street in close proximity to a superb selection of shops, cafés and transport links on nearby Holloway Road, Hornsey Road and Crouch End.

Features

- Private Garden
- Two Double Bedrooms
- Two Bathrooms
- Share of Freehold
- Good Transport Links
- Victorian conversion

Tollington Way, London, N7

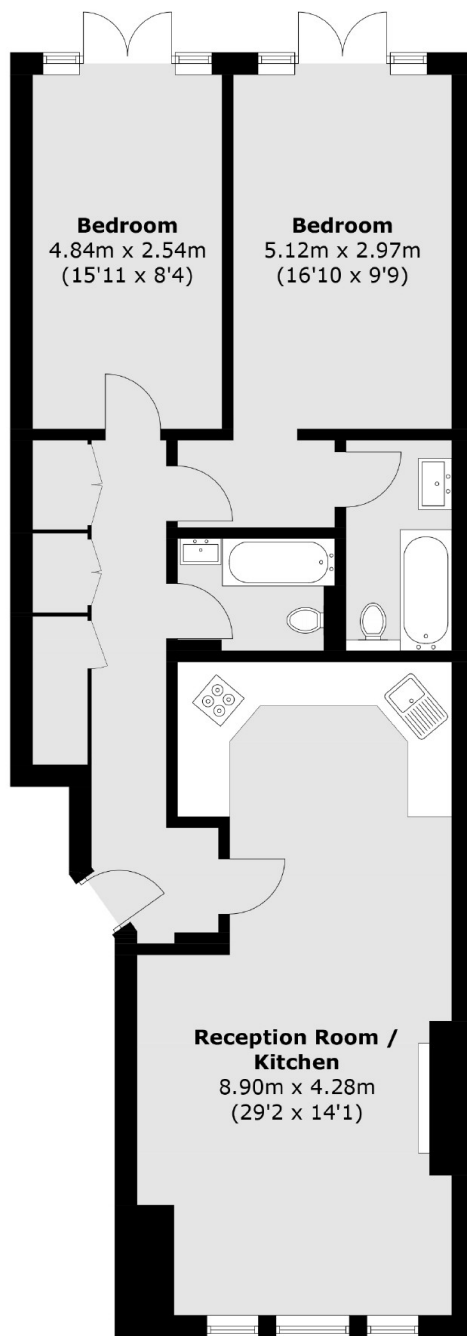

Ground Floor

Total area (approx.): 87.3 sq. m (939.7 sq. ft)