



Sussex Way, N7

£1,100,000

A four bedroom, two bathroom terraced house located on a quiet tree-lined street in the Islington borough. This house also has a separate dining room, a conservatory and a secluded garden.

Sussex Way is located just off one of the most vibrant high streets in North London, offering a wide array of shops, cafés and restaurants. Holloway Road and Archway stations are also close by.

Features

- Four Bedrooms
- Two Bathrooms
- Secluded Garden
- Freehold
- Period Features
- Unmodernised



Sussex Way, N7

Having been a family home for decades, the property could do with modernisation throughout and provides an excellent development opportunity.

Entering the property on the ground floor, there are two reception rooms, a separate kitchen and a conservatory, which has direct access to the private garden. The ground floor also has a separate WC.

On the first floor are two bedrooms and a bathroom, and on the second floor are a further two bedrooms, a bathroom and access to loft space.



Sussex Way, London, N7

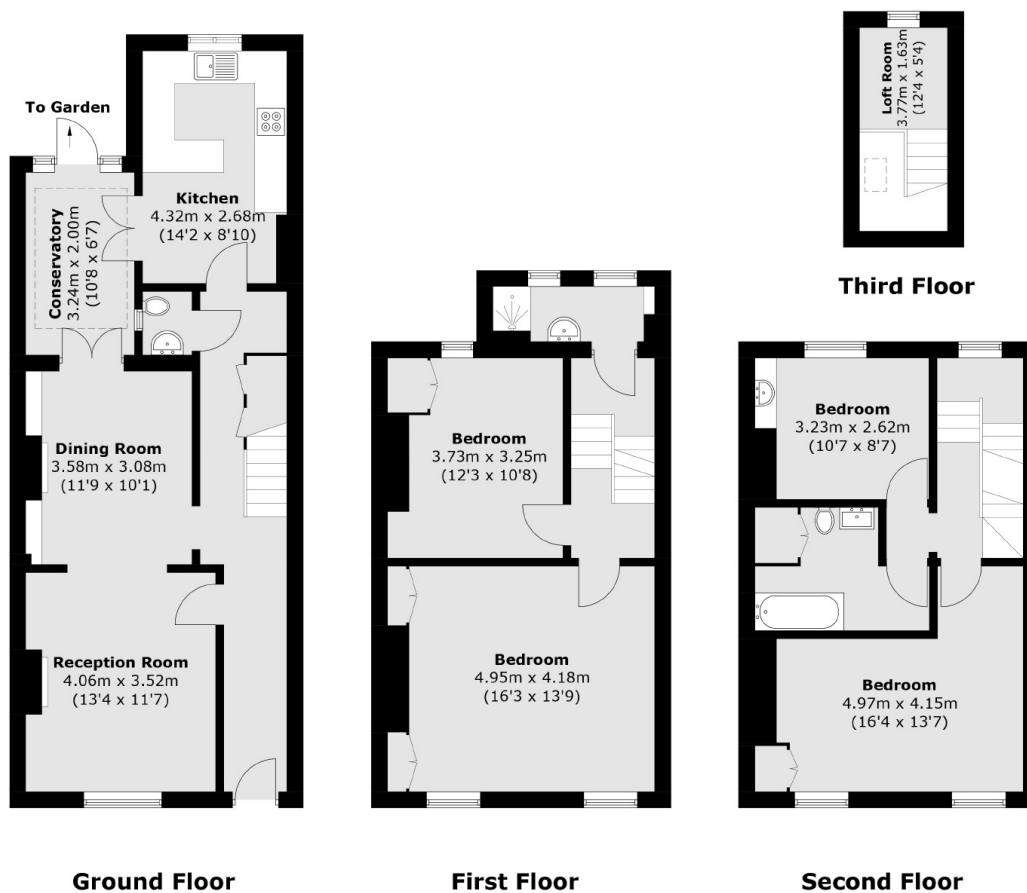

Total area (approx.): 151.5 sq. m (1,630.8 sq. ft)