



Hartham Road, N7

£475,000

A very well-presented lower ground floor flat with a private entrance. This property offers a spacious double bedroom, a large open plan reception room and a large shared garden.

Hartham Road is well located between popular locations such as Islington, Tufnell Park, Camden Town, Kings Cross/St Pancras and Coal Drops Yard shopping complex, which has a variety of shops, bars and restaurants.

Features

- Private Entrance
- Large Garden
- Recently Renovated
- Open Plan Kitchen
- Conservation Area
- Great Transport Links

Hartham Road, London, N7

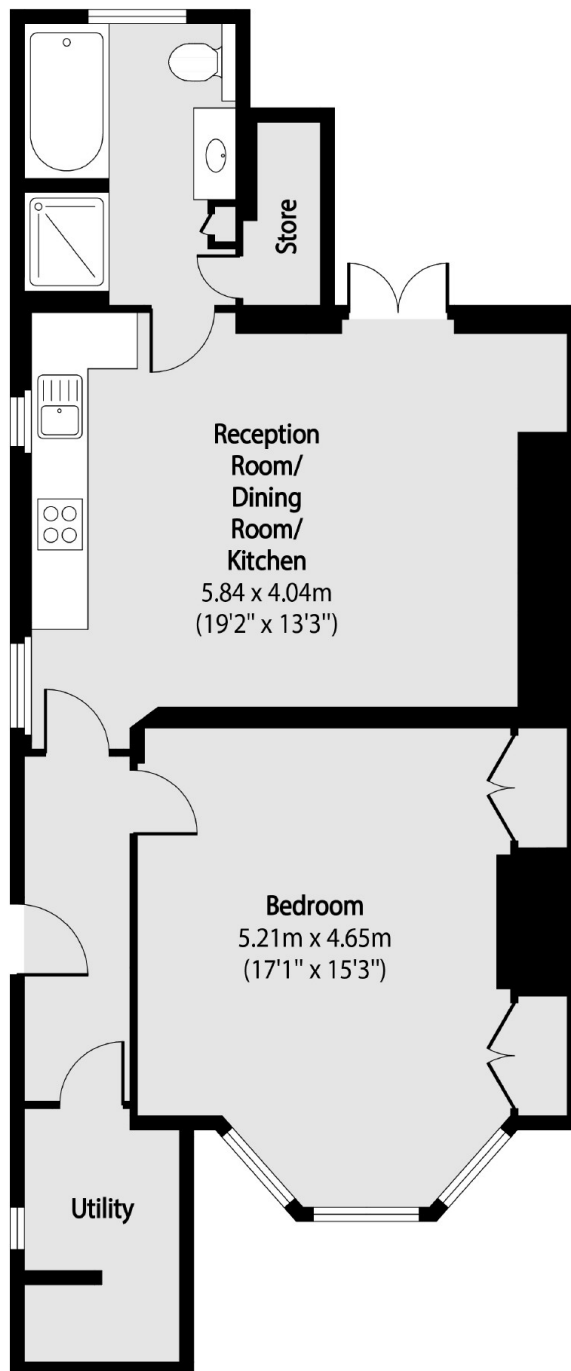

Total area (approx): 65.87 sq m (709 sq. ft)