



Fairmead Road, N19

£450,000

A ground floor split-level flat in a Victorian house with a private entrance. The ground floor provides a reception room, kitchen and bedroom, and downstairs you will find a bathroom and a large storage area. This property also benefits from a private patio.

Fairmead Road is a residential tree-lined road in Tufnell Park and within the Yerbury school catchment. The property is close to Campdale Playing Fields and the transport links of both Archway and Tufnell Park.

Features

- Split-Level
- Private Entrance
- Private Patio
- Residential Road
- Ground Floor
- Good Transport Links

Fairmead Road, London, N19

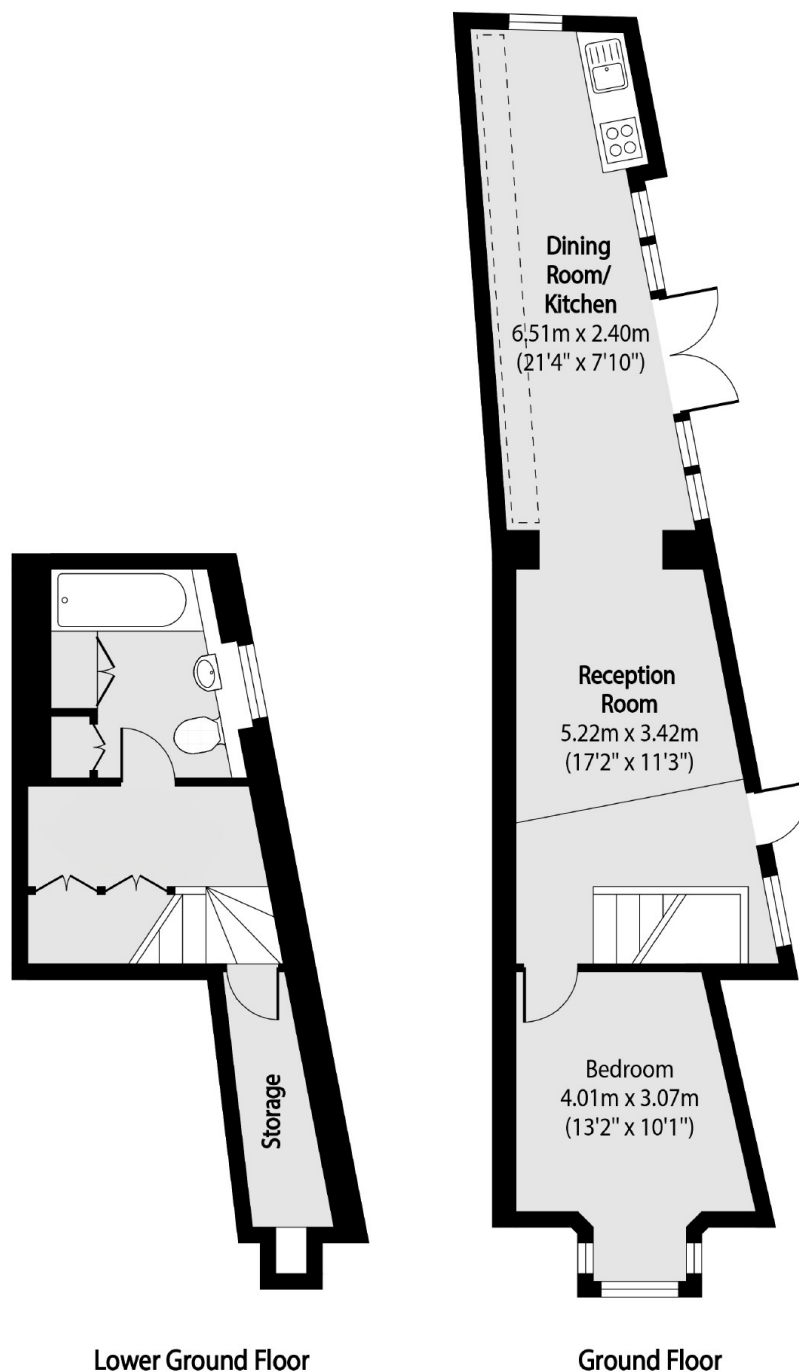

Total area (approx): 56.84 sq m (612 sq. ft)