



## Landseer Road, N19

£625,000

A two bedroom split-level apartment on the upper levels of a Victorian house. This property has a spacious reception room, a large separate kitchen, a separate bathroom and also offers direct access to a terrace.

Landseer Road is tree-lined with easy access to a local park. This property is a quarter of a mile from one of North London's busiest High Streets, with a wide variety of shops, cafés and restaurants.

### Features

- Two Double Bedrooms
- Split-Level
- Private Terrace
- Leasehold
- Victorian Conversion
- Great Transport Links

# Landseer Road, London, N19

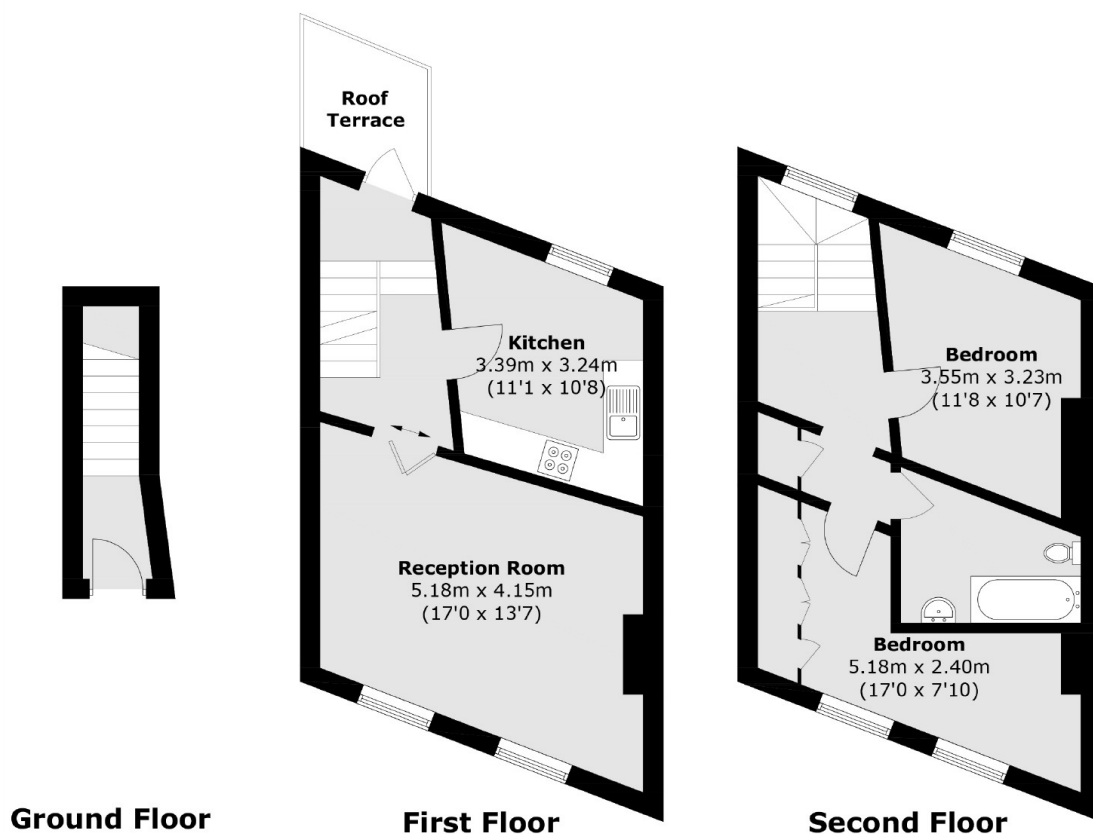

Total area (approx.): 75.7 sq. m (814.8 sq. ft)  
Roof Terrace: 3.6 sq. m (38.7 sq. ft)