



## Crescent Road, N8

£2,550 Per calendar month

A bright and spacious three-bedroom flat ideally located close to Crouch End Broadway. The property features a separate modern kitchen, a generous reception room, three double bedrooms, and two bathrooms. The property also has access to a large communal terrace.

Crescent Road is conveniently located for the shops, cafés and restaurants on Crouch End Broadway, as well as the amenities and transport links of both Archway and Highgate.

### Features

- Three Double Bedrooms
- Two Bathrooms
- Communal Garden
- Wrap Around Terrace
- High Ceilings

# Crescent Road, London, N8

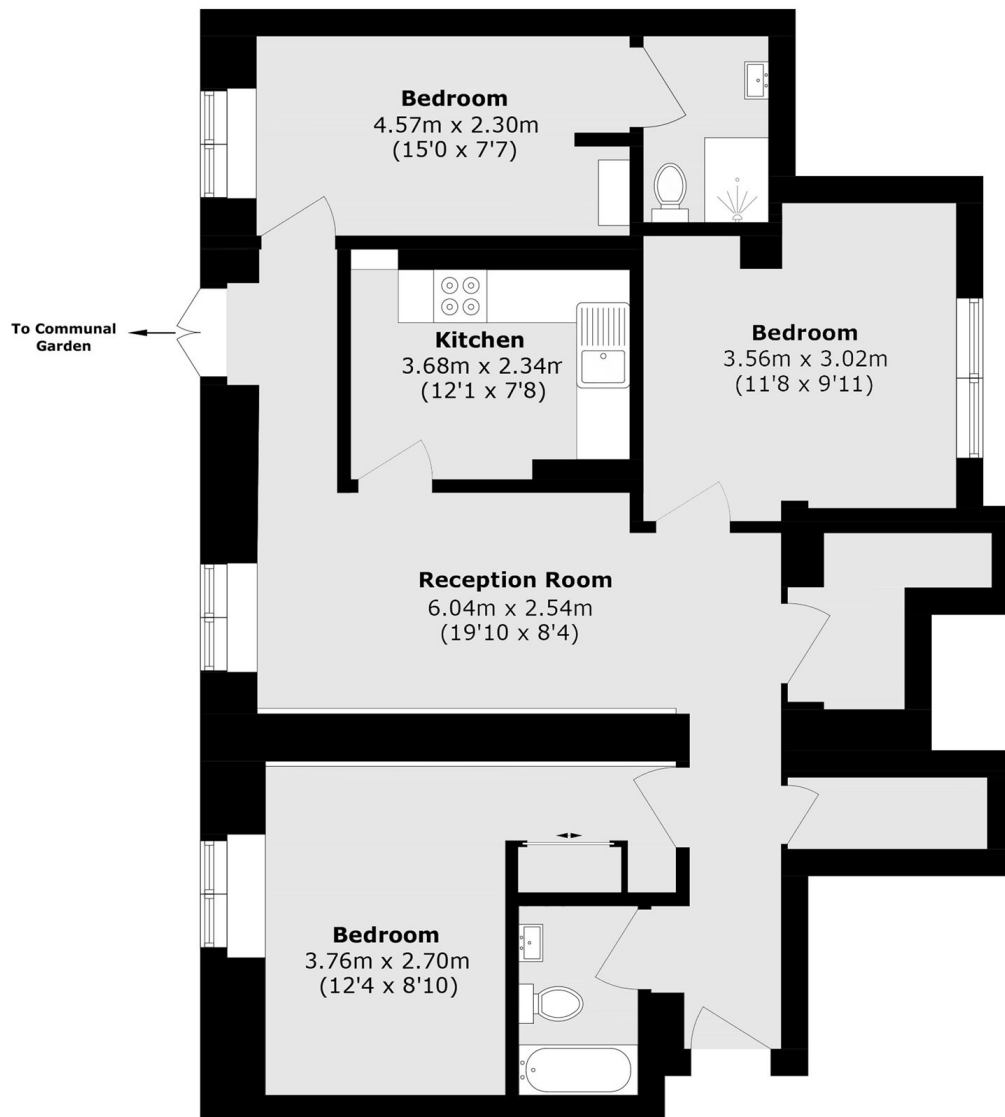

Total area (approx.): 86.7 sq. m (993.2 sq. ft)

## Dexters

Highgate  
35A Highgate High Street  
London  
N6 5JT  
Lettings  
020 8545 8585

Energy Rating: . We aim to make our particulars both accurate and reliable. However they are not guaranteed; nor do they form part of an offer or contract. If you require clarification on any points then please contact us, especially if you're traveling some distance to view. Please note that appliances and heating systems have not been tested and therefore no warranties can be given as to their good working order.

 **RICS** | Regulated  
Estate Agent  
and Letting Agent

[dexters.co.uk](https://www.dexters.co.uk)