



Herons Lea, N6

£2,900 Per calendar month

A spacious three bedroom apartment with a private balcony on the first floor of a popular block in a great location. The property has a generous sized reception room, three double bedrooms and access to communal gardens.

Situated on a highly respected and quiet tree lined avenue, Herons Lea is located between the local tube stations and has Hampstead Heath at the top of the road.

Features

- Three Double Bedrooms
- First Floor
- Communal Gardens
- Spacious
- Great Location

Herons Lea, London, N6

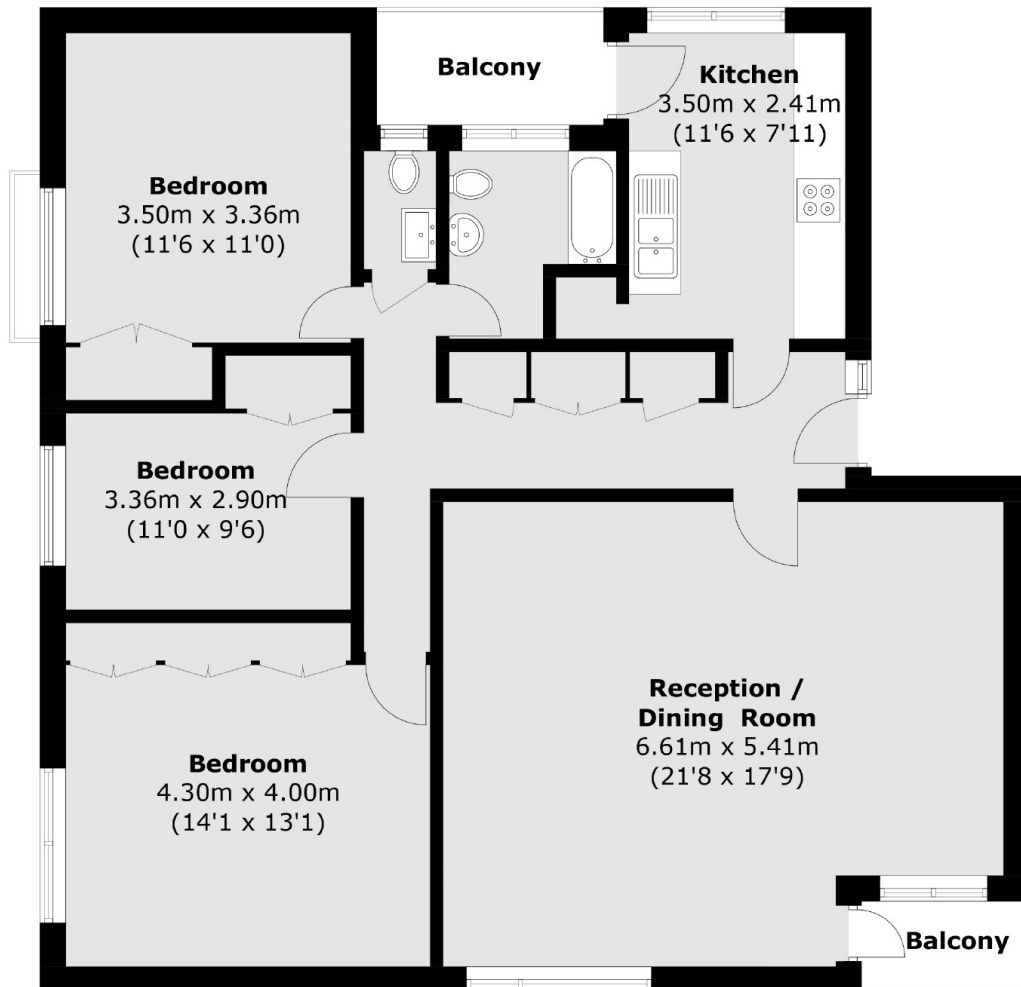

Total area (approx.): 102.1 sq. m (1098.9 sq. ft)
Balcony area: 4.0 sq. m (43.0 sq. ft)