



Hornsey Lane, N6

£485,000

A bright upper floor flat with spacious reception area, open plan kitchen and a balcony within this popular block with communal gardens and the benefit of garage parking.

Well located for access into Crouch End with its shops and restaurants there is also easy access to Highgate Village and transport connections to the tube.

Features

- Double Bedroom
- Reception Room
- Balcony
- Communal Gardens
- Garage Parking
- Bicycle Storage

Hornsey Lane, London, N6

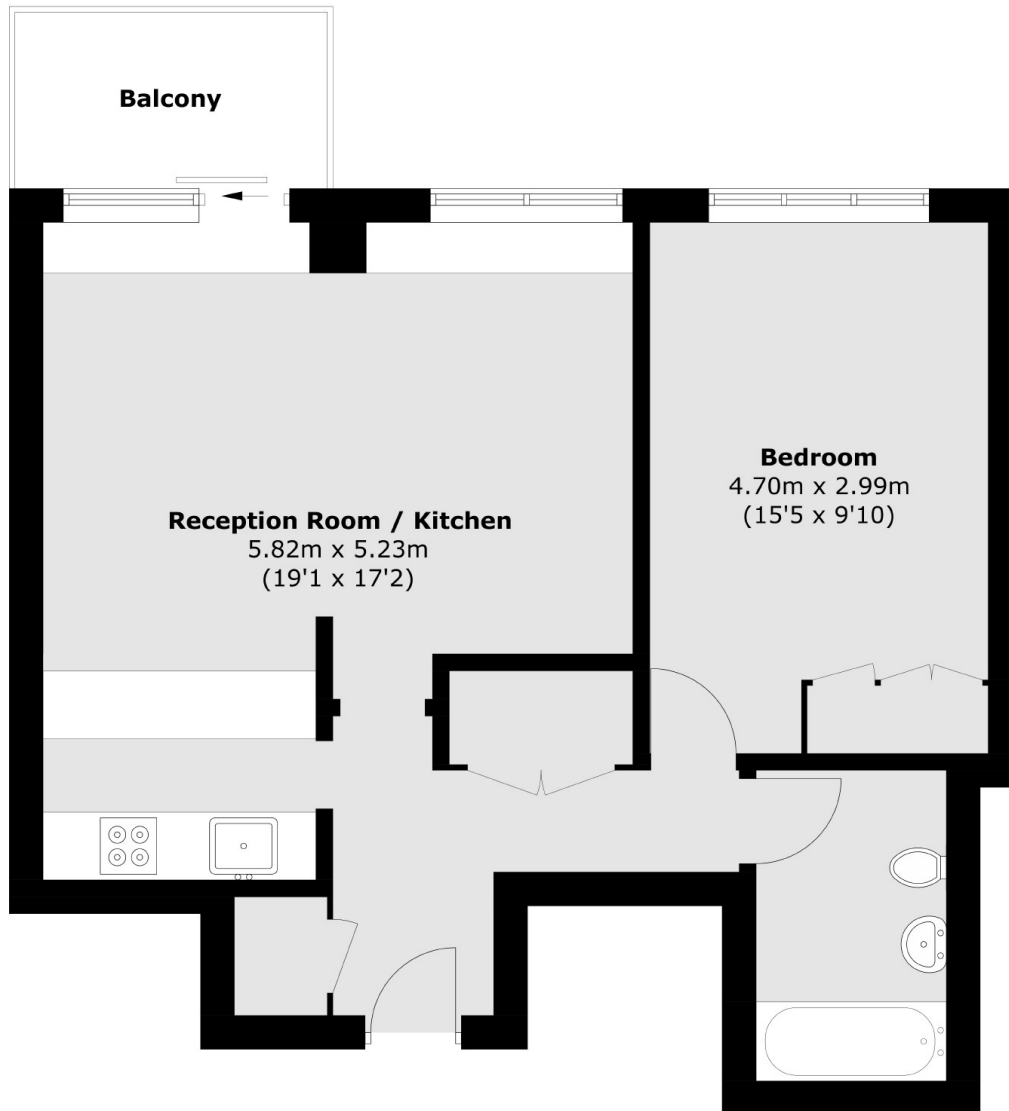

Total area (approx.): 54.0 sq. m (581.2 sq. ft)
Balcony area (approx.): 4.3 sq. m (46.3 sq. ft)