



## St. Albans Villas, NW5

£2,200 Per calendar month

A bright and spacious top-floor split-level two double bedroom maisonette with communal garden opposite Hampstead Heath.

St Albans Villas is well situated for access to Hampstead Heath as well as Highgate Village, Gospel Oak and Tufnell Park.

### Features

- Top Floor
- Split Level
- Two Double Bedrooms
- Separate Kitchen
- Communal Garden
- Opposite Heath

# St. Albans Villas, London, NW5

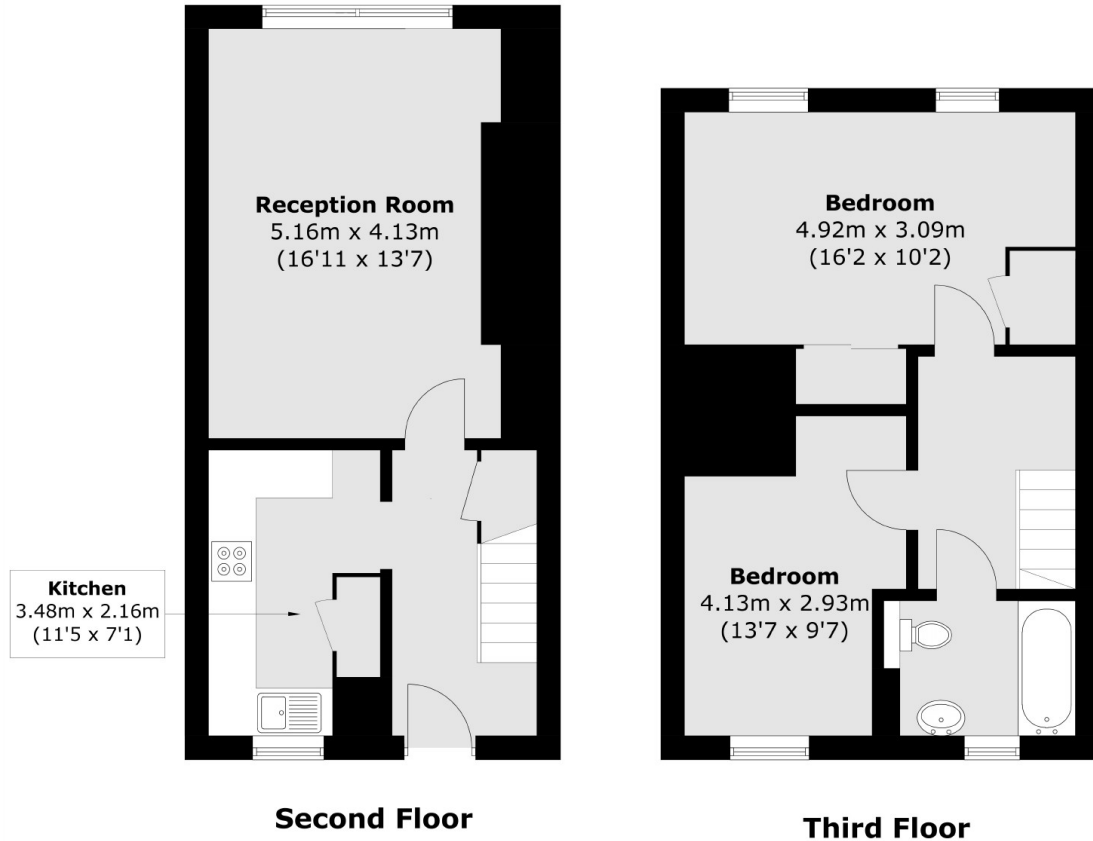

Total area (approx.): 75.6 sq. m (813.6 sq. ft)