



Bloomfield Road, N6

£1,700,000

Dexters



Bloomfield Road, N6

A spacious garden apartment converted from a substantial Victorian home providing a private street entrance, large terrace, lawned garden and secure parking.

Architecturally re-modelled providing large open entertainment areas and a kitchen breakfast room overlooking the delightful gardens, the flexible accommodation extends to over 1650 sq ft.

There are three bedrooms, a study, shower room, family bathroom and a useful utility area along with good storage including a small cellar and external storage shed.

The garden is well laid out with a large terrace for al fresco dining, a generous lawn ideal for children, a secret lower area, separate sauna and direct access to parking.

Perfectly placed between the village, Highgate underground and the woodland/parks, there is easy access to a number of local and highly rated schools.

Features

- Three Bedrooms
- Two Reception Rooms
- Kitchen/Breakfast Room
- Study Area
- Large Garden
- Private Parking







Bloomfield Road, London, N6

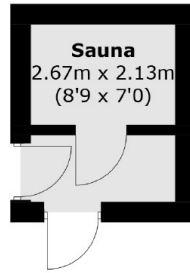

(Not Shown In Actual
Location / Orientation)

(Not Shown In Actual
Location / Orientation)

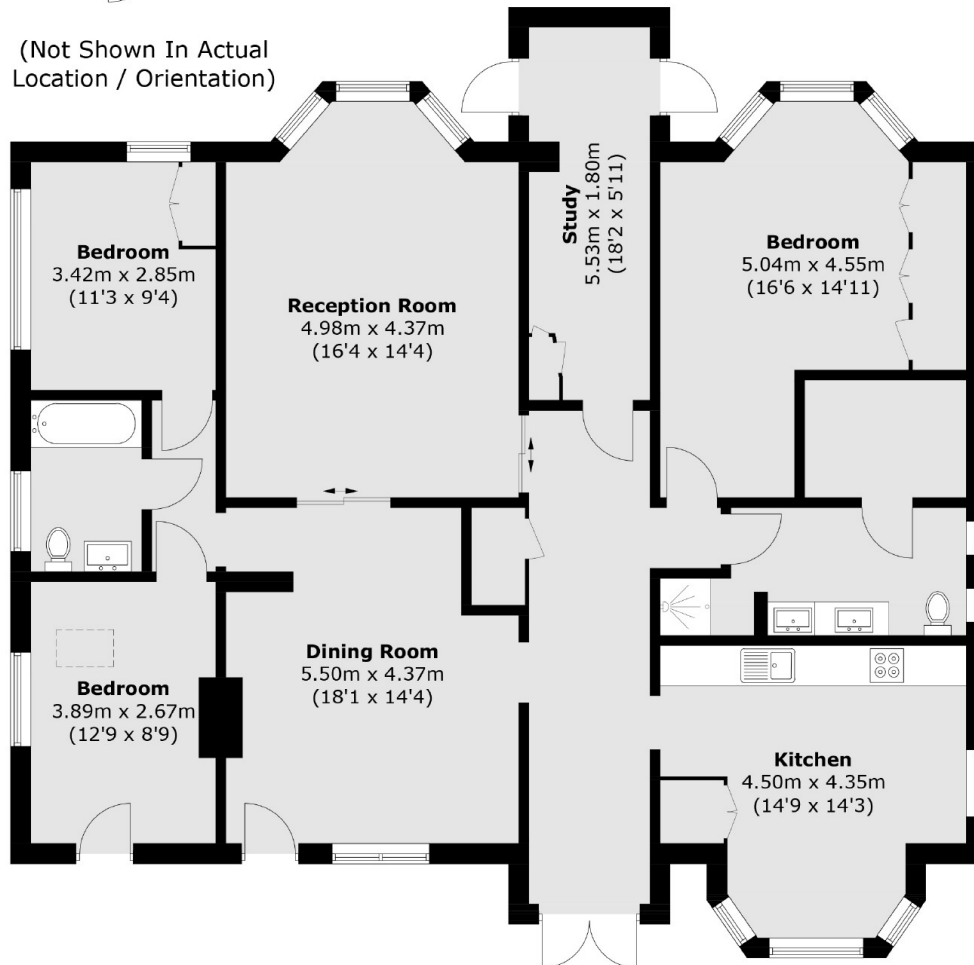

Ground Floor

Total area (approx.): 154.0 sq. m (1,657.6 sq. ft)

Outbuildings: 13.3 sq. m (143.2 sq. ft)