



Langbourne Avenue, N6

£1,000,000

A very well presented apartment, enjoying an impressive reception room and dining area with a balcony that has far reaching views, a modern kitchen and large communal gardens.

Delightfully positioned in a popular residential enclave, moments from the local independent shops, cafés and transport at Swains Lane and within easy reach of Hampstead Heath and Waterlow Park

Features

- Three Bedrooms
- Reception Room
- Dining Area
- Separate Kitchen
- Balcony
- Communal Gardens



Langbourne Avenue, N6

Fully restored by the present owner, this spectacular home provides the perfect balance of modernity and character filled with natural light and in an enviable location.



Langbourne Avenue, London, N6

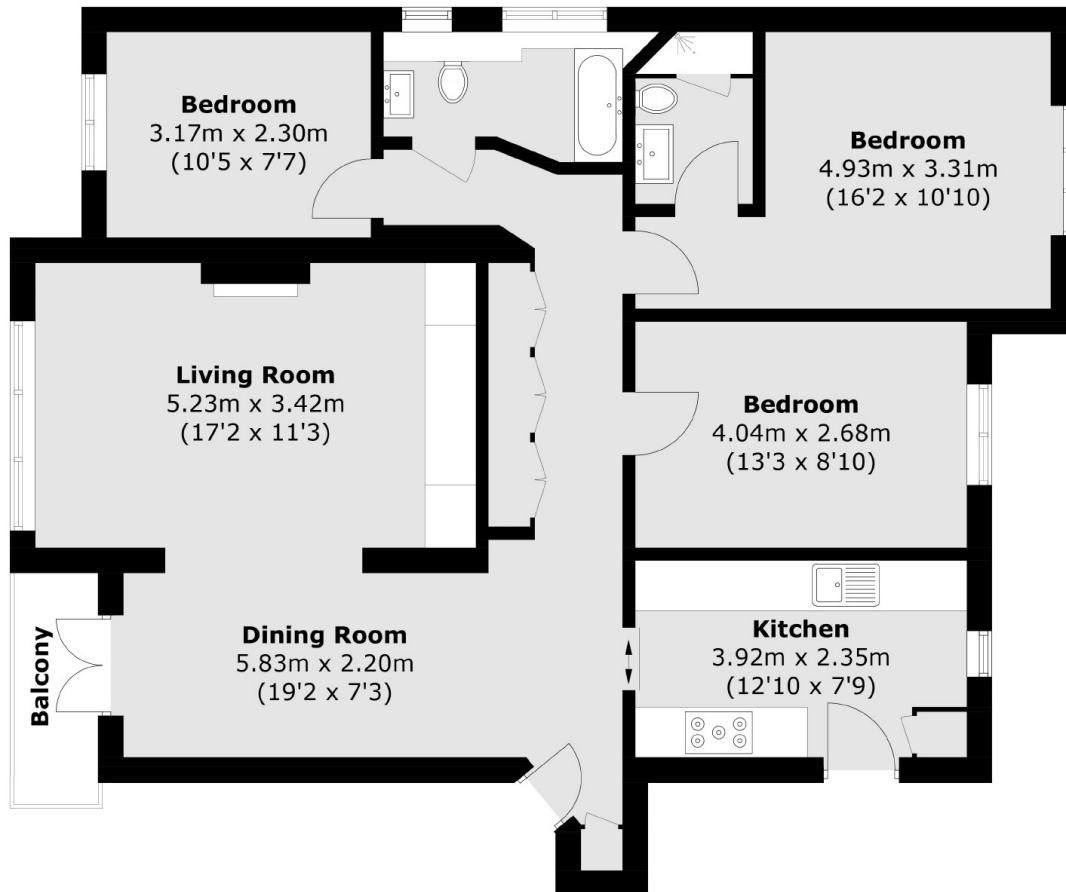

Total area (approx.): 95.9 sq. m (1032.2 sq. ft)
Balcony area (approx.): 2.9 sq. m (31.2 sq. ft)