



Prince Arthur Road, NW3

£500,000

A well-proportioned one double bedroom ground floor apartment in an exceptionally convenient Hampstead location. The property features a bright reception room, separate kitchen, and access to first come, first served parking. Further benefits include a caretaker/porter and immediate proximity to Hampstead High Street.

Situated just off Hampstead High Street, Greenhill offers unrivalled convenience with cafés, boutiques, and everyday amenities moments away. Hampstead Heath is within easy reach, providing expansive green space for walks and leisure. Excellent transport links include Hampstead Underground Station (Northern Line) and Hampstead Heath Overground.

Features

- One Double Bedroom
- Long Lease
- Separate Kitchen
- Excellent Location
- Northern Line
- Approximately 500 Sq.Ft

Prince Arthur Road, London, NW3

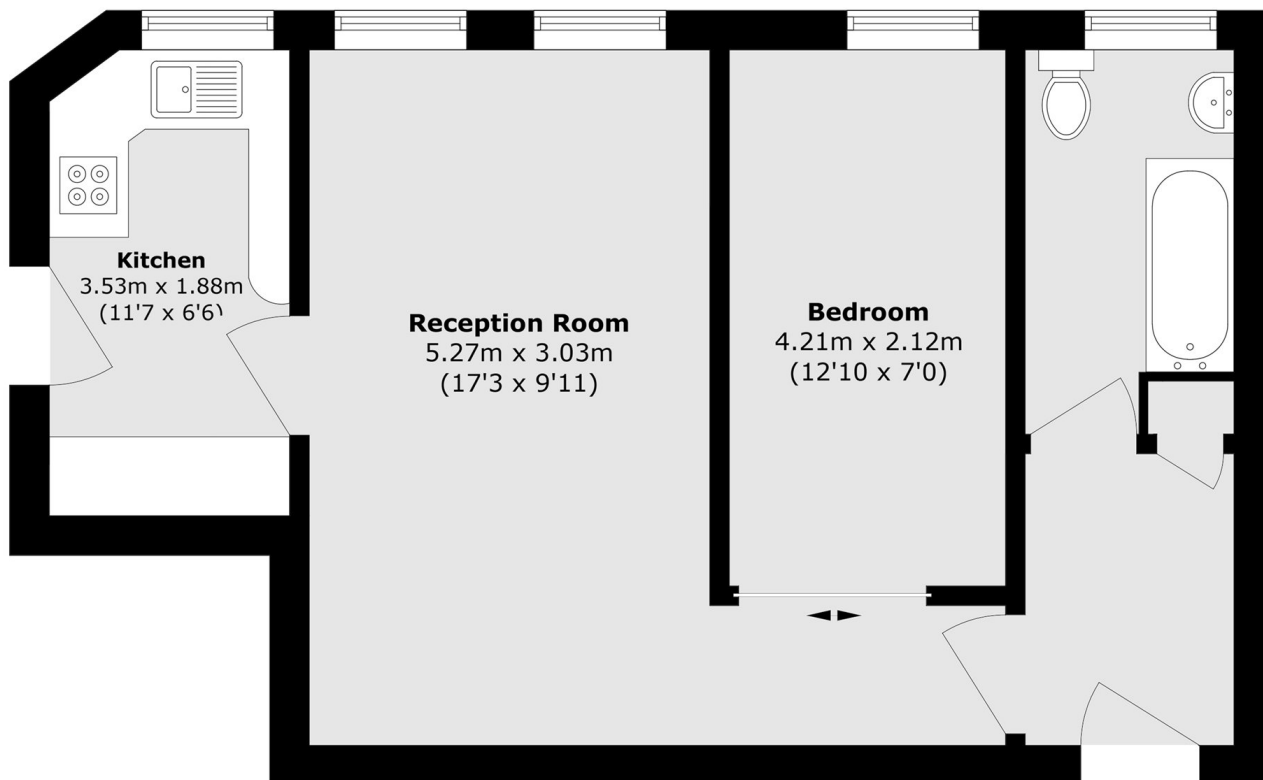

Total area (approx.): 44.7 sq. m (481.1 sq. ft)