



## Finchley Road, NW11

### £450,000

This lateral, two double bedroom, purpose built apartment, located a short distance from Golders Green Station. The large 20ft reception room has a separate office space and the separate kitchen is also a very good size. There is gated access to the rear of the building with a communal garden and private single garage.

The property is conveniently located 0.5 miles away from Golders Green underground station (Northern Line) with the amenities, restaurants and cafés of both Golders Green and Temple Fortune just as near. Hampstead Heath Extension is also 0.5 miles away.

### Features

- Two Double Bedrooms
- Top Floor Flat
- Purpose Built
- Separate Kitchen
- Communal Garden
- Single Garage

# Finchley Road, London, NW11

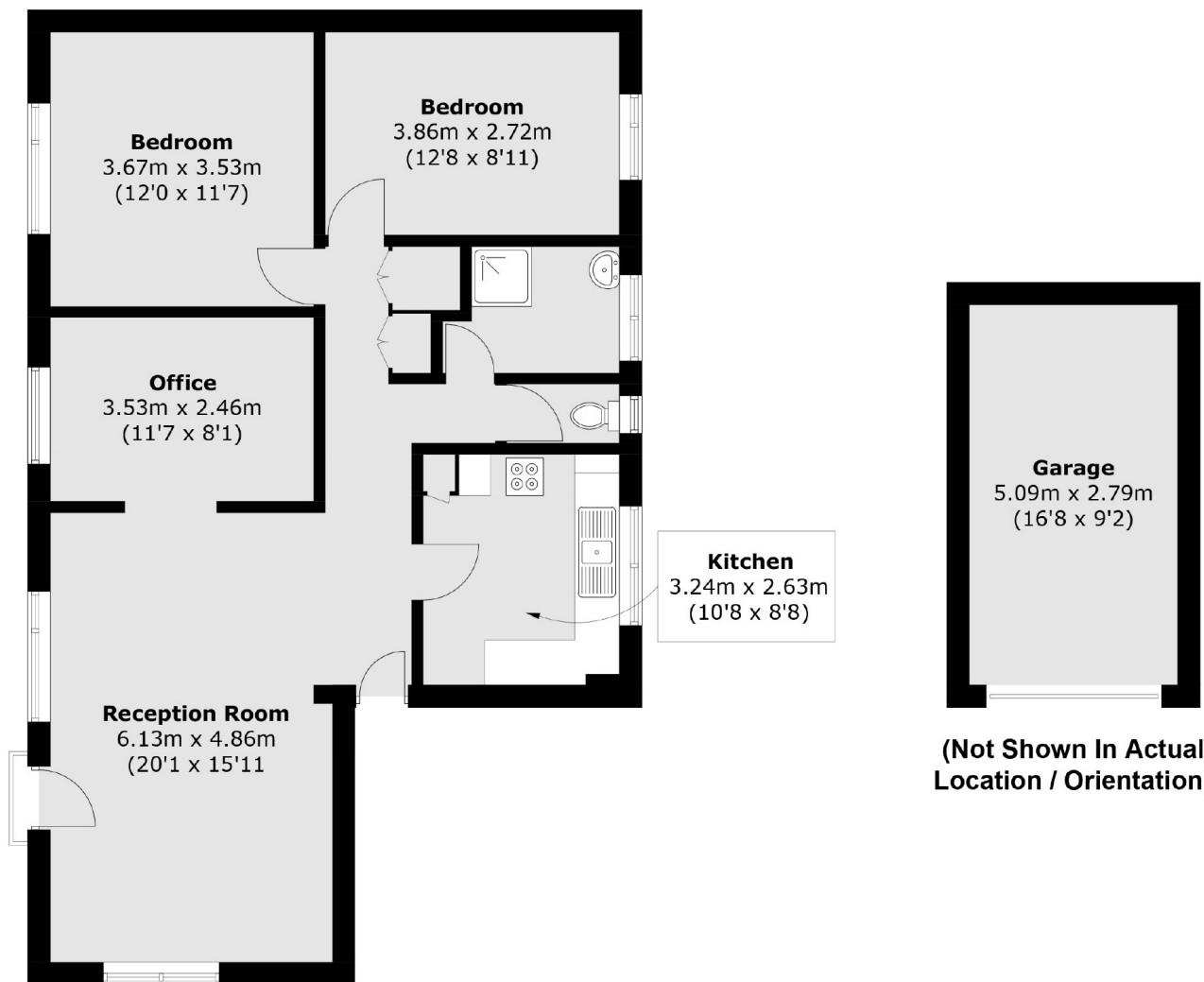

## Second Floor

Approx Internal Area: 80.8 sq. m (869.7 sq. ft)  
Garage: 14.2 sq. m (152.8 sq. ft)