



## Finchley Road, NW11 £250,000

A spacious studio apartment positioned within this popular Art Deco Grade II listed, offering bright and stylish accommodation throughout including a separate modern kitchen and well maintained communal gardens.

A purpose built block set back off the Finchley Road in Temple Fortune with access to an array of shops, restaurants, and transport links including both Marks & Spencers and Waitrose.

### Features

- Studio
- Chain Free
- Communal Gardens
- Grade II Listed
- Art Deco
- Ideal for Investors

Finchley Road,  
London, NW11

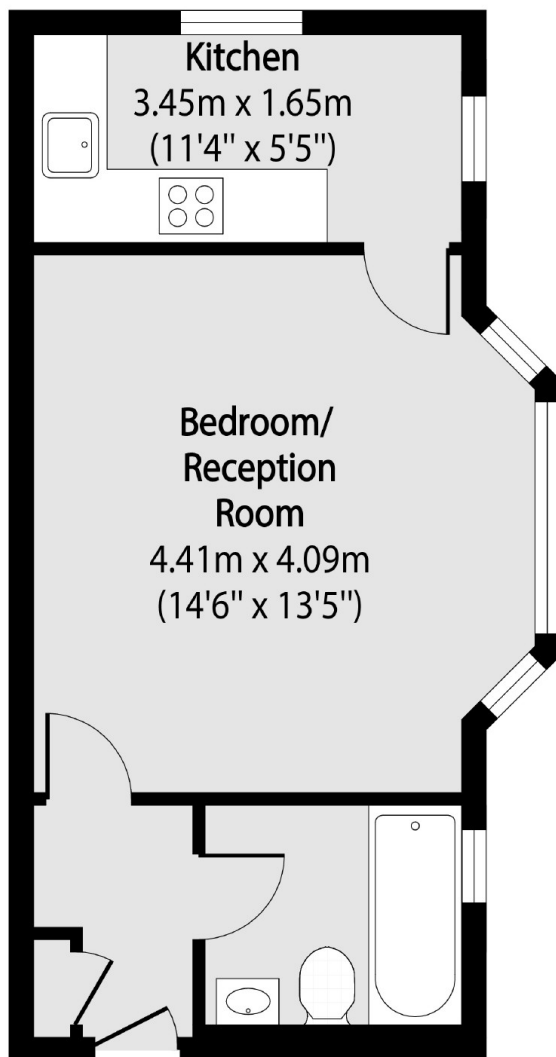

Total area (approx): 31.10 sq m (324 sq. ft)

**Dexters**

Hampstead  
56 Heath Street  
London  
NW3 1DL  
Sales  
020 7433 0273

Energy Rating: D. We aim to make our particulars both accurate and reliable. However they are not guaranteed; nor do they form part of an offer or contract. If you require clarification on any points then please contact us, especially if you're traveling some distance to view. Please note that appliances and heating systems have not been tested and therefore no warranties can be given as to their good working order.

 **RICS** | Regulated  
Estate Agent  
and Letting Agent

dexters.co.uk