



## Maitland Park Villas, NW3

### £550,000

The spacious and well-proportioned apartment has three double bedrooms, a bright open-plan kitchen-living room with a sunny balcony, and a modern bathroom.

Set within a vibrant neighbourhood with a wide range of local amenities and entertainment, this flat has excellent transport links and is located within easy walking distance to Chalk Farm underground and Kentish Town West Overground.

### Features

- Three Double Bedrooms
- Long Lease
- Private Balcony
- Lift Access
- Chin Free
- Recently Modernised

# Maitland Park Villas, London, NW3

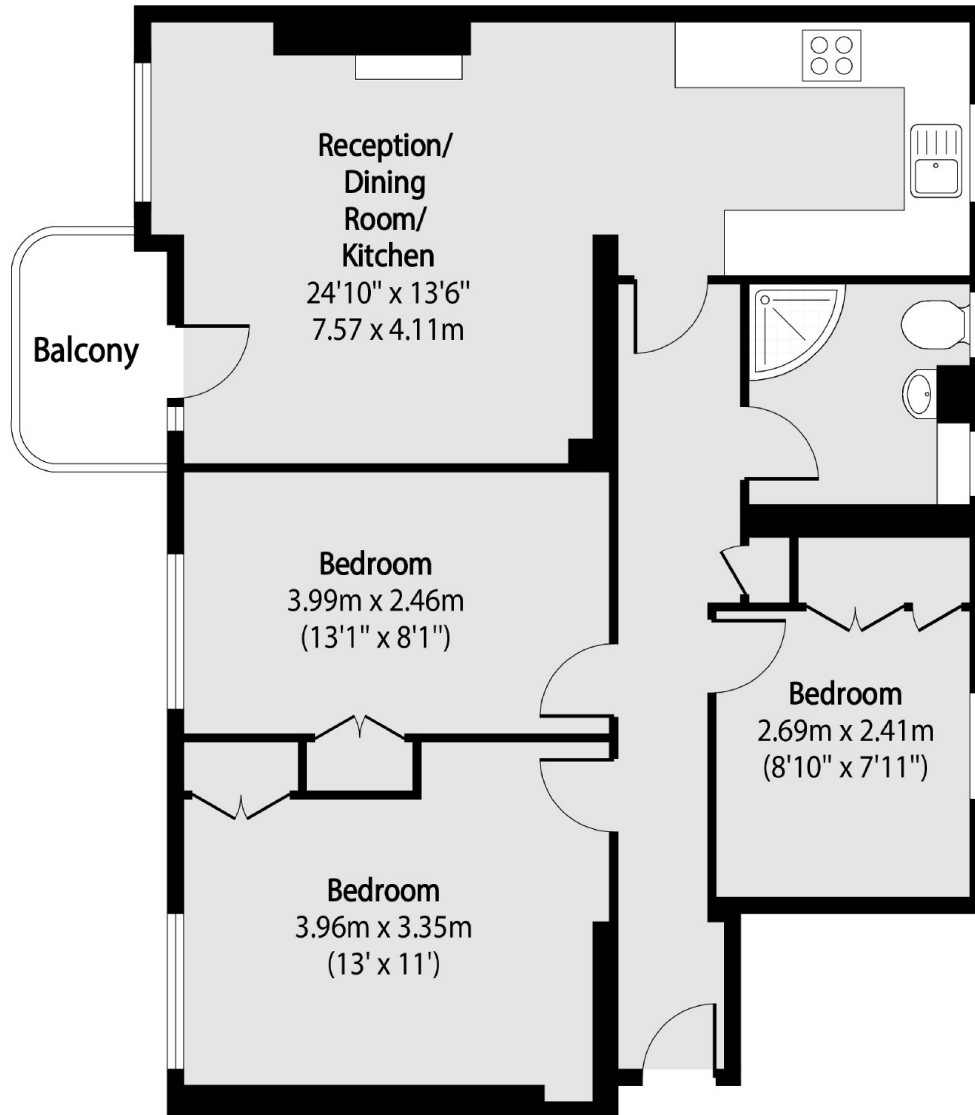

Total area (approx): 68.93 sq m (742 sq. ft)

Balcony total area (approx): 2.88 sq m (31 sq. ft)