



Landseer Close, Black Dam, Basingstoke

Offers Over £150,000

BELVOIR!



PROPERTY:

This well-presented one-bedroom first-floor maisonette is situated in a popular and convenient location in Black Dam, offering easy access to local amenities, the town centre as well as the beautiful open spaces of the Crabtree plantation and Basingstoke common.

ACCOMMODATION:

The property comprises an entrance hall with storage space and steps to the first floor which has a living room. Kitchen, bedroom and bathroom. The kitchen has a range of fitted units and a separate breakfast bar area with an aspect to the rear.

The property benefits from gas heating and double glazing throughout, ensuring a warm and comfortable living environment. The property also benefits its own private entrance.

Overall, this well-maintained and tastefully presented property would make an ideal home for first-time buyers, investor buyers or those looking to downsize.

LOCATION:

The property is located in a quiet cul-de-sac in Black Dam, just a short distance from Basingstoke town centre with its extensive range of amenities, facilities and services as well as the beautiful open spaces of the Crabtree plantation and Basingstoke common.

LOCAL AUTHORITY - BASINGSTOKE & DEANE

COUNCIL TAX - Tax band A

TENURE - LEASEHOLD - LEASE 999 years from 2008





Score	Energy rating	Current	Potential
92+	A		
81-91	B		
69-80	C	78 C	78 C
55-68	D		
39-54	E		
21-38	F		
1-20	G		

Energy efficiency chart

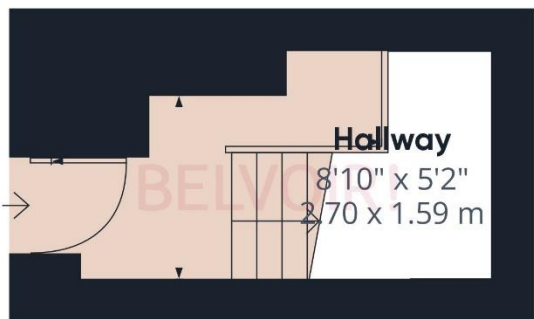

Ground Floor

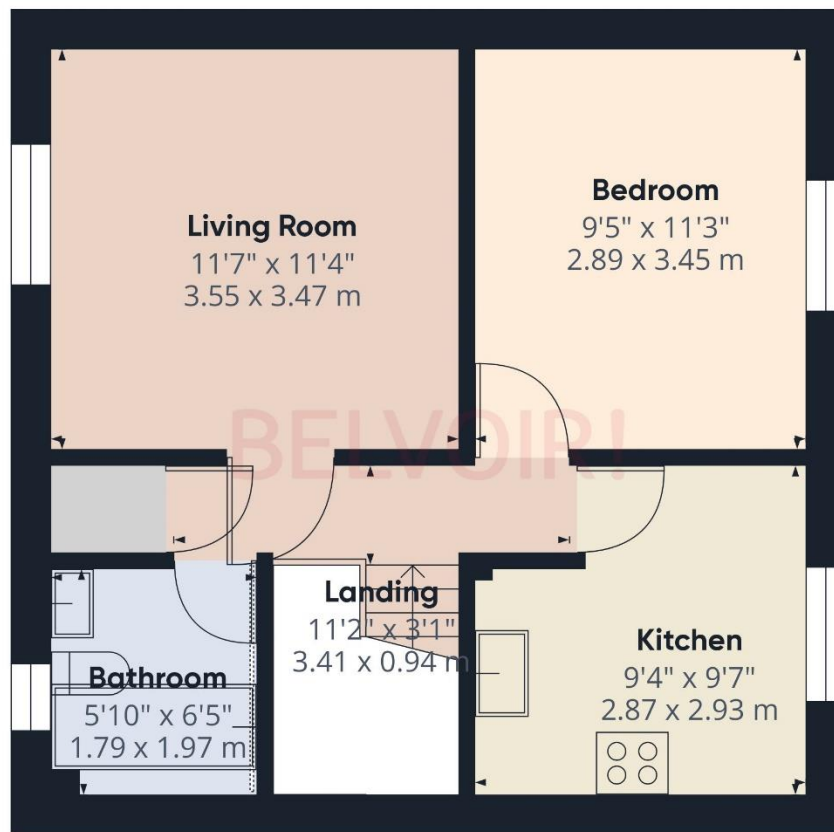

Floor 1

Approximate total area^①

469.04 ft²

43.57 m²

Excluding balconies and terraces

While every attempt has been made to ensure accuracy, all measurements are approximate, not to scale. This floor plan is for illustrative purposes only.

GIRAFFE360

Contact us today to arrange a viewing...

www.belvoir.co.uk/offices/basingstoke

BELVOIR!

01256 830800