



Coach House Carters Lane, Tiddington

Offers Over **£575,000**

Coach House Carters Lane

Tiddington, Stratford-Upon-Avon

Beautifully renovated 3 bed home in Tiddington Village with original features, modern kitchen diner, private courtyard, ensuite, off road parking, and versatile living spaces.

Council Tax band: E

Tenure: Freehold

EPC Energy Efficiency Rating: D

EPC Environmental Impact Rating: D

- Charming Period Property
- Refurbished & Renovated Throughout
- Two Reception Rooms
- Kitchen Diner
- Three Bedrooms
- High Specification Shower Room & En-Suite Bathroom
- Private Enclosed Courtyard Garden
- Off Road Parking
- Highly Sought After Tiddington Village Location
- No Onward Chain





GROUND FLOOR
567 sq.ft. (52.7 sq.m.) approx.

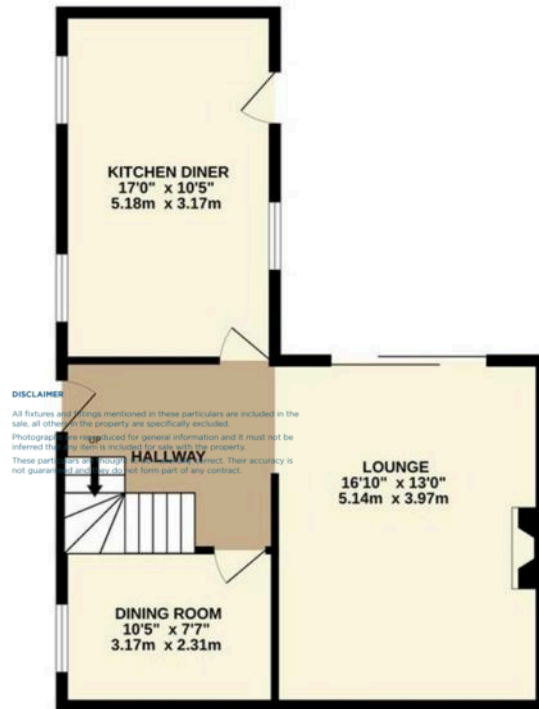

1ST FLOOR
658 sq.ft. (61.1 sq.m.) approx.



TOTAL FLOOR AREA : 1225 sq.ft. (113.8 sq.m.) approx.
This floor plan is not to scale and is for guidance purposes only
Made with Metropix ©2025

Sheldon Bosley Knight Stratford-Upon-Avon

Sheldon Bosley Knight, 35-36 Rother Street - CV37 6LP

01789387887 · stratfordsales@sheldonbosleyknight.co.uk · www.sheldonbosleyknight.co.uk/

DISCLAIMER

All fixtures and fittings mentioned in these particulars are included in the sale, all others in the property are specifically excluded.

Photographs are reproduced for general information and it must not be inferred that any item is included for sale with the property.

These particulars are thought to be materially correct. Their accuracy is not guaranteed and they do not form part of any contract.