



Ash Place, Alcester, B50 4GB

**SHELDON
BOSLEY
KNIGHT**

LAND AND
PROPERTY
PROFESSIONALS

Property Description

*Ideal First Time Buy or Buy To Let Investment *

Nestled in the charming village of Bidford-On-Avon, is this modern, well appointed home.

Upon entering, you are welcomed into an open plan living space with a feature media wall. There are double doors leading out to the enclosed rear garden. The area benefits from a handy storage cupboard, which also doubles up as housing for your washing machine and the added advantage of a downstairs WC

Upstairs there are two well appointed double bedrooms, with the principal boasting fitted wardrobes. The bathroom has been upgraded and features a rainfall shower over bath.

Located in the picturesque setting of Bidford-On-Avon, residents can enjoy the tranquillity of village life while being just a short distance from the amenities of Alcester. The area is known for its scenic beauty, with the River Avon nearby, offering opportunities for leisurely walks and outdoor activities.





Key Features

- Cul-De-Sac Location
- Well Presented Modern Home
- 2 Double Bedrooms
- Open Plan Living Space With Feature Media Wall
- Downstairs WC
- Handy Downstairs Storage
- Family Bathroom
- Allocated Parking
- Enclosed Rear Garden
- Within 1 Mile Of Bidford High Street

£230,000



Ground Floor

Approx. 30.4 sq. metres (327.5 sq. feet)

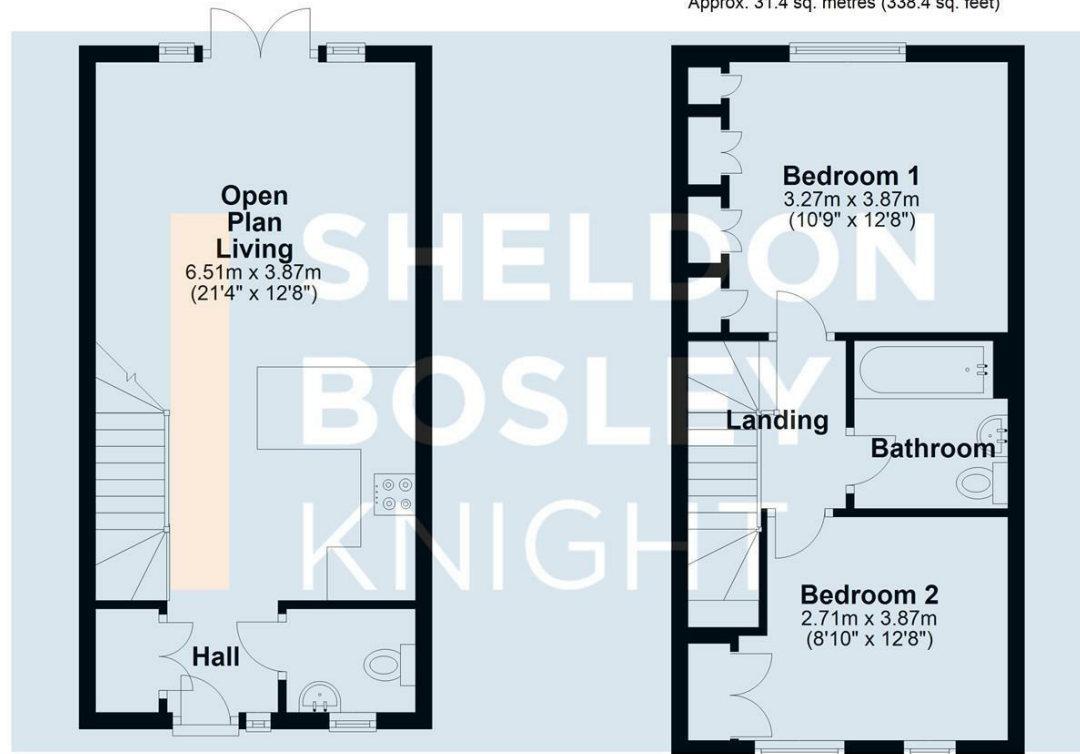

First Floor

Approx. 31.4 sq. metres (338.4 sq. feet)

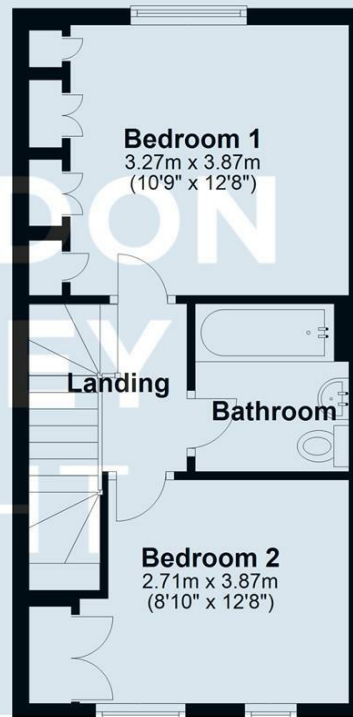

Total area: approx. 61.9 sq. metres (665.9 sq. feet)

All efforts have been made to ensure that the measurements on this floorplan are accurate however these are for guidance purposes only.
Plan produced using PlanUp.



EPC Rating - C

Tenure - Freehold

Council Tax Band -

Local Authority



We routinely refer clients to both our recommended legal firm and a panel of financial services providers. It is your decision whether you choose to deal with these companies. In making that decision, you should know that we receive a referral fee.

**SHELDON
BOSLEY
KNIGHT**

LAND
AND
PROPERTY
PROFESSIONALS