



Chesterton Drive, Stratford-Upon-Avon, CV37 7LG

**SHELDON  
BOSLEY  
KNIGHT** LAND AND  
PROPERTY  
PROFESSIONALS



# Property Description

This handsome, three storey semi detached property is offered for sale with the benefit of having no upward chain. Offering sizeable accommodation throughout, with driveway for off road parking and single garage.

The property comprises of hallway with downstairs cloakroom, and shaker style kitchen with a front aspect. A large through reception room with wide panelled wood laminate flooring, seamlessly flows through the lounge/diner. A large conservatory, with a set of two double french patio doors, provides plenty of natural light into this spacious room, allowing you to enjoy the garden view.

The first floor accommodation includes, two double bedrooms with the family bathroom, whilst the top floor provides the large master bedroom has an en-suite and a the fourth double bedroom, gives far reaching views can be enjoyed from the top rear bedroom.







# Key Features

- Semi-detached, three storey home
- No Chain
- Garage and driveway
- Four Bedrooms
- Large through Reception Room
- Conservatory
- Two Bathrooms
- Downstairs Cloakroom

**Price Guide**  
**£325,000**

EPC Rating - C

Tenure - Freehold

Council Tax Band - E

Local Authority -  
Startford Upon Avon District

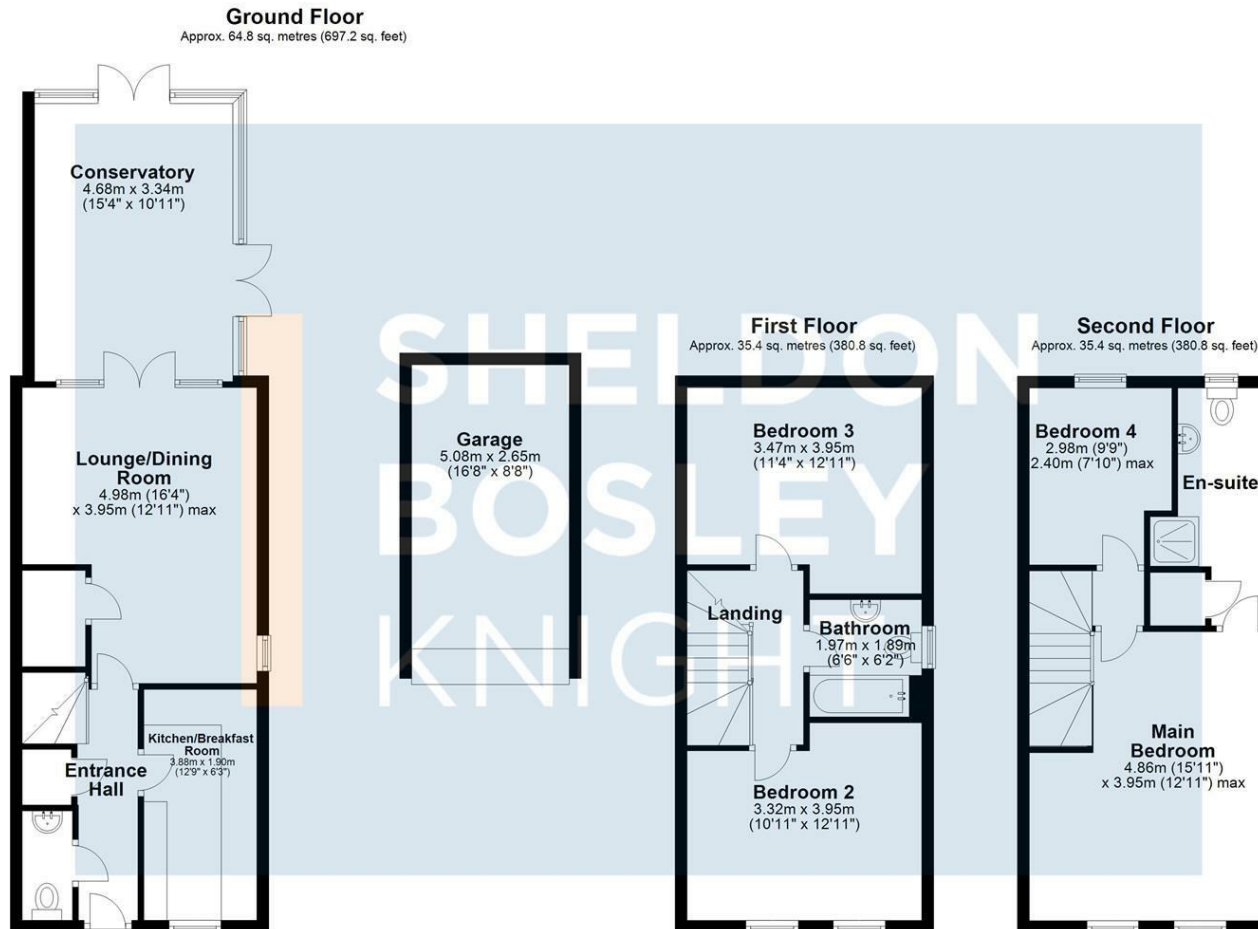

Total area: approx. 135.5 sq. metres (1458.7 sq. feet)

All efforts have been made to ensure that the measurements on this floorplan are accurate however these are for guidance purposes only.  
Plan produced using PlanUp.

We routinely refer clients to both our recommended Legal Firm and a panel of Financial Services Providers. It is your decision whether you choose to deal with these companies. In making that decision, you should know that we receive a referral fee