



Scholars Court, Stratford-upon-Avon, CV37 6PN

**SHELDON
BOSLEY
KNIGHT**

LAND AND
PROPERTY
PROFESSIONALS

Property Description

Situated close to Stratford Town Centre, Sheldon Bosley Knight are pleased to bring to the market this purpose built, ground floor retirement apartment, having the benefit of UPVC double glazing throughout, central heating and patio doors into the communal gardens.

The accommodation briefly comprises - entrance hall, with 24 hour emergency call system and built-in storage, leading to a lounge/dining room with feature fireplace and double glazed French doors leading out to the communal gardens. An archway leads to the kitchen with range of base and eye level units, including a built-in oven and hob, with extractor fan. The double bedroom incorporates built-in wardrobes. The bathroom includes an off-white suite with shower over bath.

Outside, the development benefits from neatly landscaped communal gardens including a patio area and residents parking. There are a wide range of additional facilities available within this McCarthy Stone development and the property is being offered for sale with vacant possession no upward chain.

Location: Stratford-upon-Avon is Internationally famous as the birthplace of William Shakespeare, home to the Royal Shakespeare Theatre and attracts almost four million visitors a year. Stratford is also a prosperous riverside market town with fine restaurants and inns, a good choice of public and private schools and excellent sporting and recreational amenities. The town is ideally placed for access to the M40, other major road and rail networks, and Birmingham International Airport.





Key Features

- Convenient Town Centre Location
- Within Easy Reach To A Wealth Of Local Amenities
- Ground Floor McCarthy Stone Purpose Built Retirement Apartment
- No Upward Chain & Vacant Possession
- Easy Access To Communal Gardens
- Viewing Highly Recommended
- Well Kept Communal Areas
- Development Manager and 24 Hour Emergency Call System
- Minimum Age 60

£90,000



Ground Floor

Approx. 41.8 sq. metres (449.7 sq. feet)

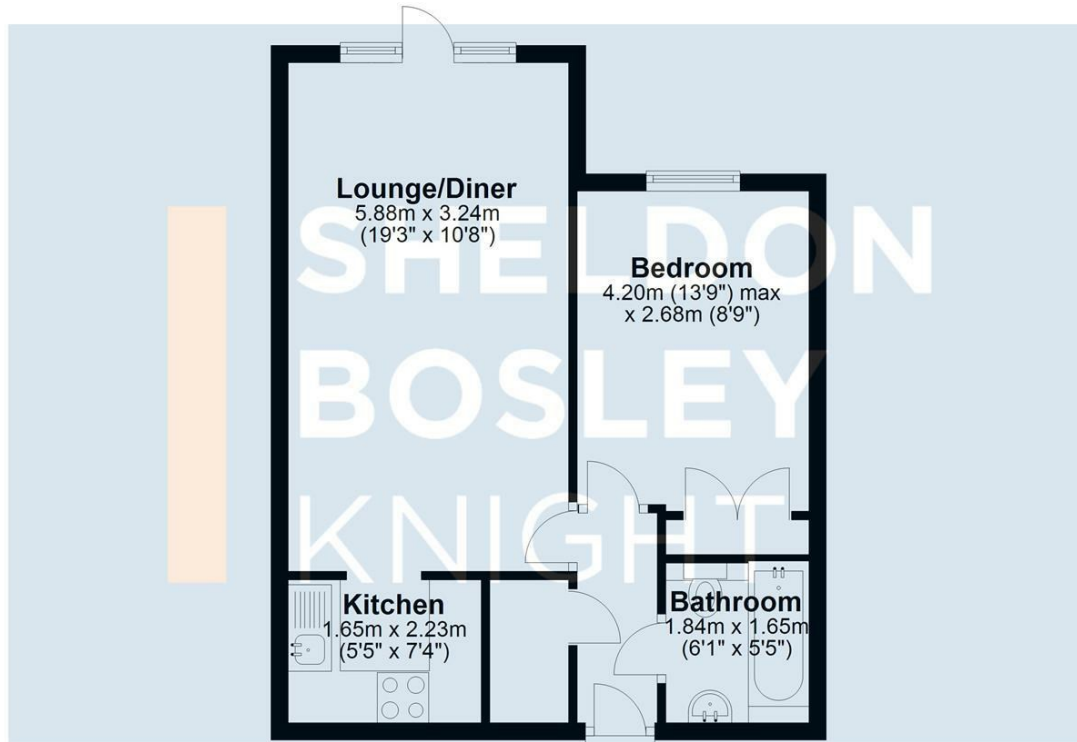

Total area: approx. 41.8 sq. metres (449.7 sq. feet)

All efforts have been made to ensure that the measurements on this floorplan are accurate however these are for guidance purposes only.
Plan produced using PlanUp.



EPC Rating - C

Tenure - Leasehold

Council Tax Band - D

Local Authority
Stratford-upon-Avon District Council



We routinely refer clients to both our recommended legal firm and a panel of financial services providers. It is your decision whether you choose to deal with these companies. In making that decision, you should know that we receive a referral fee.

**SHELDON
BOSLEY
KNIGHT**

LAND AND
PROPERTY
PROFESSIONALS