



## 41 Martindale Crescent

Newtown, Wigan, WN5 9DU

**£1,000 PCM**



Sapphire Homes are delighted to offer For Rent this well presented 3 bedroom 3 storey mews which is ideally situated on the outskirts of Wigan Town Centre with good network links into Wigan and the surrounding areas. The accommodation briefly comprises of entrance / hallway leading to lounge with a downstairs W.C and Kitchen/Diner with patio doors leading to the back garden at the rear elevation. To the first floor there are 2 bedrooms with a family Bathroom and three piece suite in white. To the second floor there is a master bedroom with its own three piece shower suite en-suite and feature dormer window. The property is also carpeted throughout and has a neutral decor whilst also benefitting from GCH, DG, Off road parking and gardens to the front and rear. Internal viewing is highly recommended. No Smoking.



## GROUND FLOOR

Entrance / Hallway

Lounge

Downstairs WC

Kitchen / Diner

## FIRST FLOOR

Landing

Bedroom 2

Bedroom 3

Bathroom

## SECOND FLOOR

Master Bedroom

Ensuite

## EXTERNAL

## Area Map

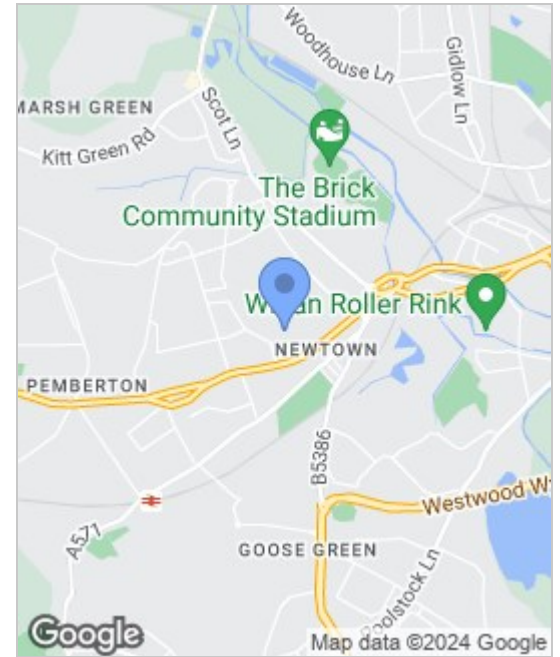

## Floor Plans

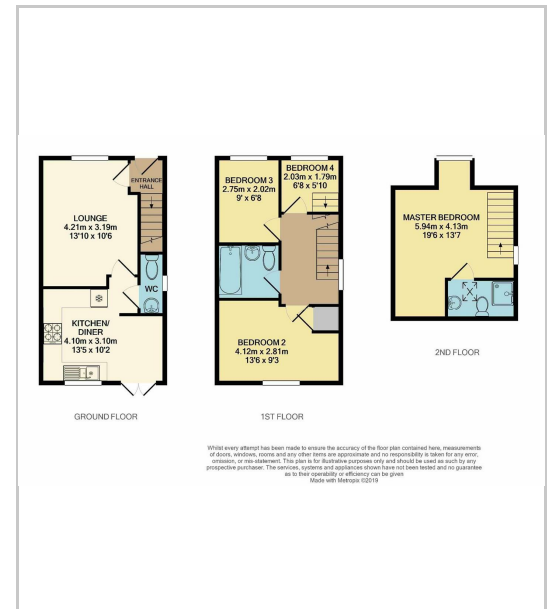

## Energy Efficiency Graph

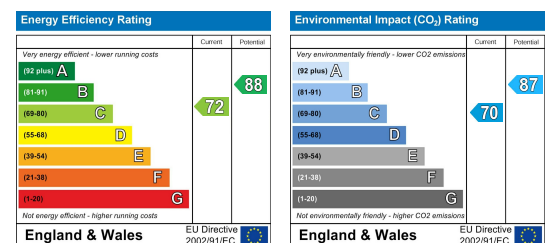

These particulars, whilst believed to be accurate are set out as a general outline only for guidance and do not constitute any part of an offer or contract. Intending purchasers should not rely on the representation of fact, but must satisfy themselves by inspection or otherwise as to their accuracy. No person in this firm's employment has the authority to make or give any representation or warranty in relation to the property.

Sapphire Homes (North) Ltd 80 Market Street, Wigan WNI 1HX  
 T 01942 494944 E info@sapphirehomes.co.uk W www.sapphirehomes.co.uk VAT 183 759 366

specialists in sales, Lettings & Property Investments