



15 Ashleigh Road, Kendal
£225,000



15 Ashleigh Road

Kendal

A semi-detached house pleasantly located to the north of Kendal offering easy access to the market town and all the local amenities as well as the M6 motorway and the Lake District National Park. This three-bedroom semi-detached bungalow offers a comfortable and convenient lifestyle in a sought-after location. The property is in need of some modernisation but would be a great first home or a investment property.

Situated within easy reach of the town centre, this property boasts a light and airy sitting room, perfect for relaxing or entertaining guests. The kitchen overlooks the rear garden, providing a serene environment while preparing meals. Three well-proportioned bedrooms offer ample space for residents or guests. The property is also complimented by a three-piece suite bathroom. The home is fitted with double glazing and gas central heating for added comfort. With no chain, this bungalow presents a hassle-free move-in opportunity.

Outside, the property is surrounded by sunlit gardens to both the front and rear, allowing residents to enjoy the outdoors in the privacy of their own home. The rear garden features a raised patio seating area, providing a charming space for soaking up the sunshine. Planting beds add a touch of greenery, enhancing the overall aesthetics of the patio area. At the front, a neatly kept lawn is complemented by flower beds, creating a welcoming entrance to the property. Additionally, the property offers an under-croft area that can be utilised for parking or storing bikes, adding extra convenience to every-day living. Driveway parking and on-street parking ensure that residents and guests have ample space for their vehicles, making this property not only a comfortable living space but a practical one as well.

- Semi-detached bungalow
- Easy access to the town centre
- Light and airy sitting room
- Double glazing and gas central heating
- Kitchen with rear garden views
- No chain
- Three bedrooms
- Gardens to the front and rear
- Three piece suite bathroom
- Ample driveway parking

IDENTIFICATION CHECKS

Should a purchaser(s) have an offer accepted on a property marketed by THW Estate Agents they will need to undertake an identification check. This is done to meet our obligation under Anti Money Laundering Regulations (AML) and is a legal requirement. We use a specialist third party service to verify your identity. The cost of these checks is £43.20 inc. VAT per buyer, which is paid in advance, when an offer is agreed and prior to a sales memorandum being issued. This charge is non-refundable.

EPC RATING D

SERVICES

Mains electric, mains gas, mains water, mains drainage

COUNCIL TAX:BAND C

TENURE:FREEHOLD

DIRECTIONS

From Kendal town centre follow Windermere Road to the traffic lights turning right onto Burneside Road. Take the fourth turning on the left on to Ashleigh Road and number 15 is located on the right.

WHAT3WORDS:status.workload.count





GROUND FLOOR

INNER HALLWAY

17' 7" x 3' 7" (5.36m x 1.09m)

SITTING ROOM

14' 7" x 11' 6" (4.45m x 3.51m)

KITCHEN

10' 6" x 7' 10" (3.20m x 2.40m)

BEDROOM

13' 11" x 8' 11" (4.25m x 2.71m)

BEDROOM

9' 10" x 8' 1" (2.99m x 2.47m)

BEDROOM

10' 0" x 6' 8" (3.06m x 2.04m)

BATHROOM

7' 0" x 4' 5" (2.14m x 1.35m)









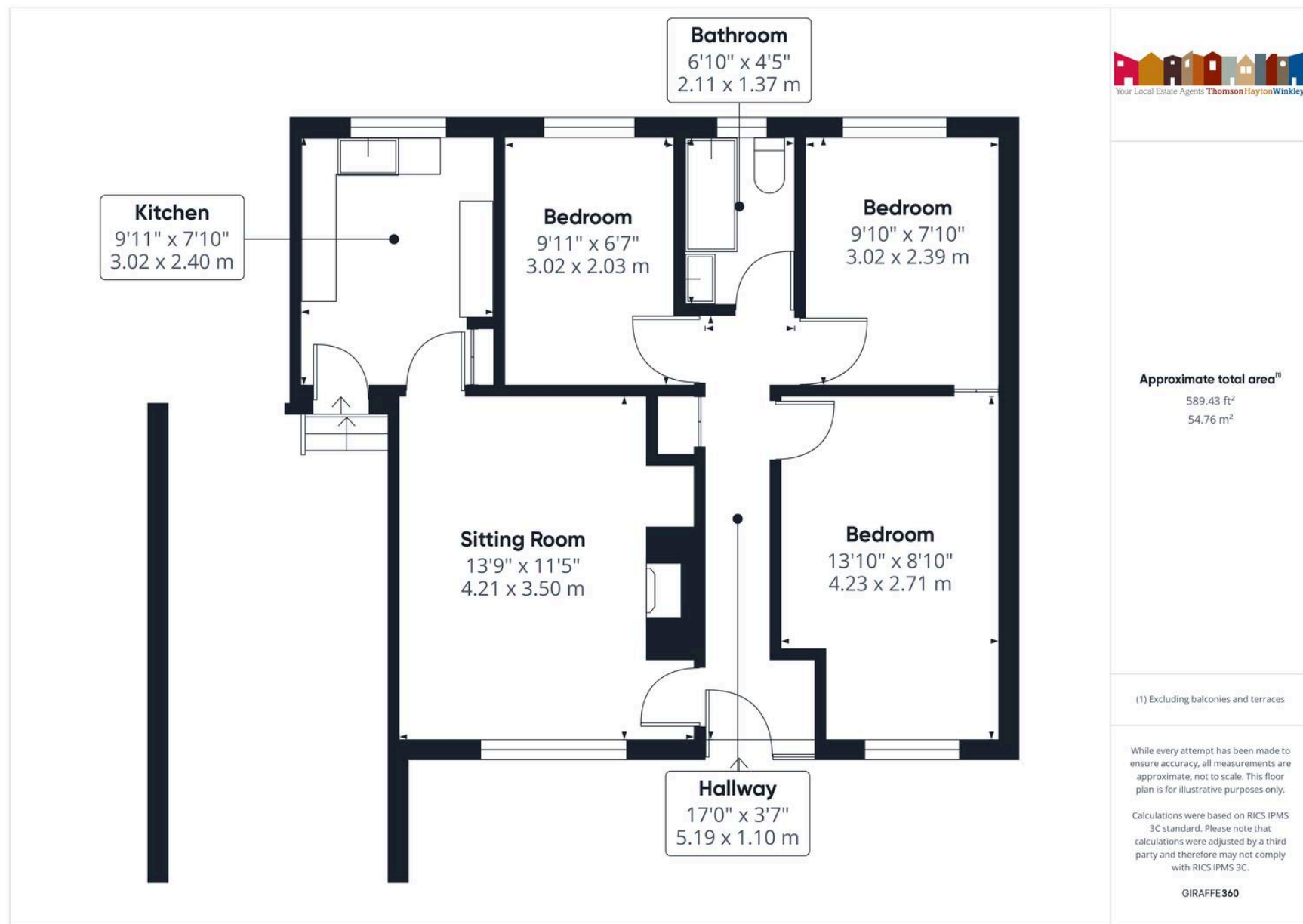

THW Estate Agents

112 Stricklandgate, Kendal - LA9 4PU

01539 815700 • kendal@thwestestateagents.co.uk • www.thwestestateagents.co.uk

Please note that descriptions, photographs and plans are for guidance only. Services and appliances have not been tested, measurements are approximate and alterations may not have necessary consents. Contact us for property availability and important details before travelling or viewing properties. THW Estate Agents Ltd is a separate legal entity to the solicitor firm of THW Legal Ltd which has different ownership and clients of THW Estate Agents Ltd do not have the same protection as those of THW Legal Ltd.