



Flat 5, 205 London Road, Portsmouth, PO2 9AJ

£650 PCM Council Tax Band A Deposit £750



Tully's



Floor Plan

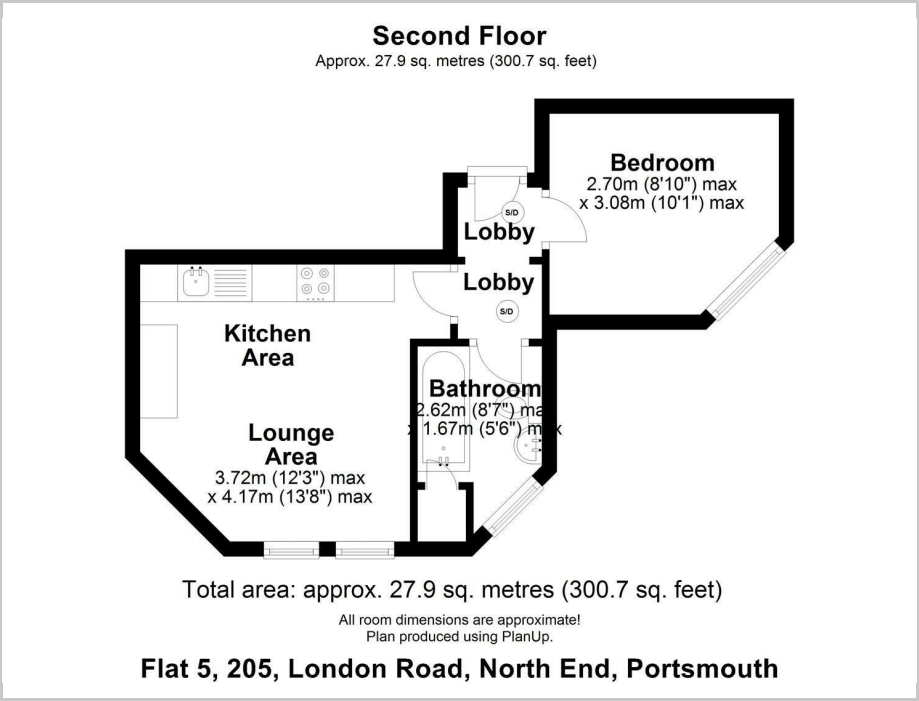

Area Map



Accommodation

- Holding Deposit - £150.00
- Deposit - £750.00
- Council Tax Band - A
- Available from 24/11/2025
- 1 Bedroom
- Pets permitted at extra £50pcm
- Available 05/12/2025
- 1st Floor
- Electric Heating

Viewing

Please contact our Southsea Office on 023 9273 2241 if you wish to arrange a viewing appointment for this property or require further information.

Energy Efficiency Graph

