



Flat 18, West Court Highland Road, Portsmouth, PO4 9HA

£950 Per Month Council Tax Band A Deposit £1,096



2



1



1



C

Tully's



Floor Plan

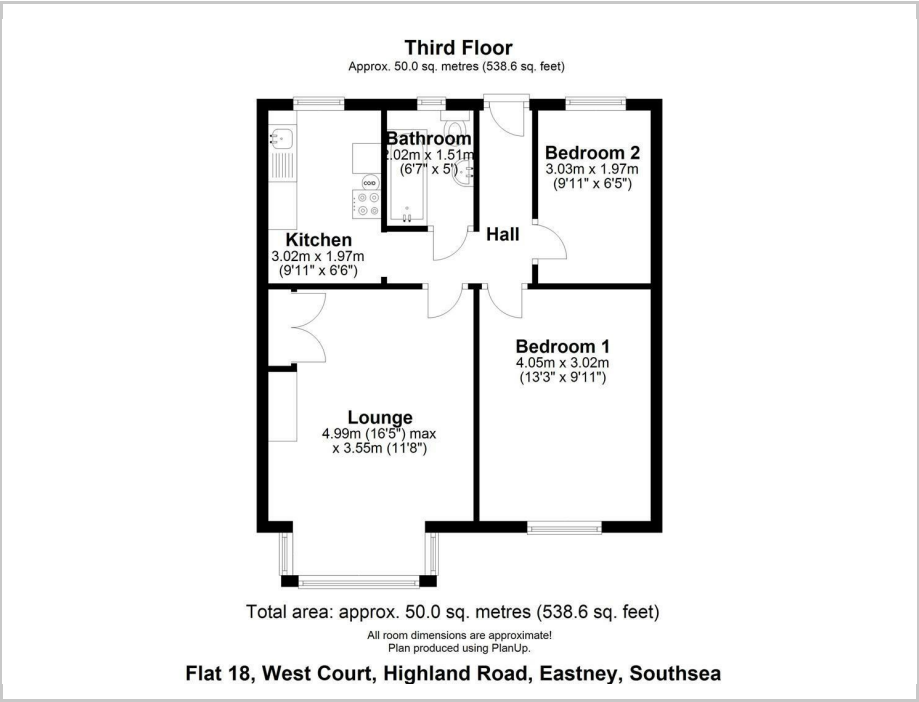

Area Map

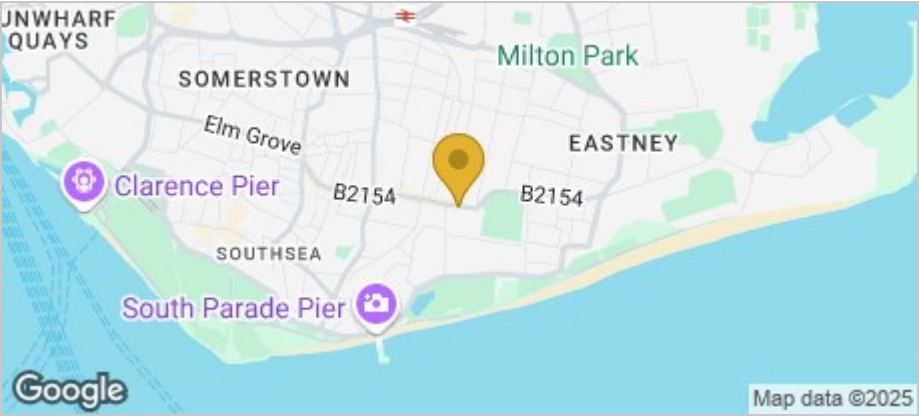

Accommodation

- Holding deposit - £219.00
- Deposit - £1096.00
- 2 Bedrooms
- Pets permitted (not dogs) at extra £25pcm
- large lounge
- Available now
- Southsea location

Viewing

Please contact our Southsea Office on 023 9273 2241 if you wish to arrange a viewing appointment for this property or require further information.

Energy Efficiency Graph

