



98 Stamshaw Road, Portsmouth, PO2 8LU

£1,100 PCM Council Tax Band B Deposit £1,269



Tully's

Floor Plan

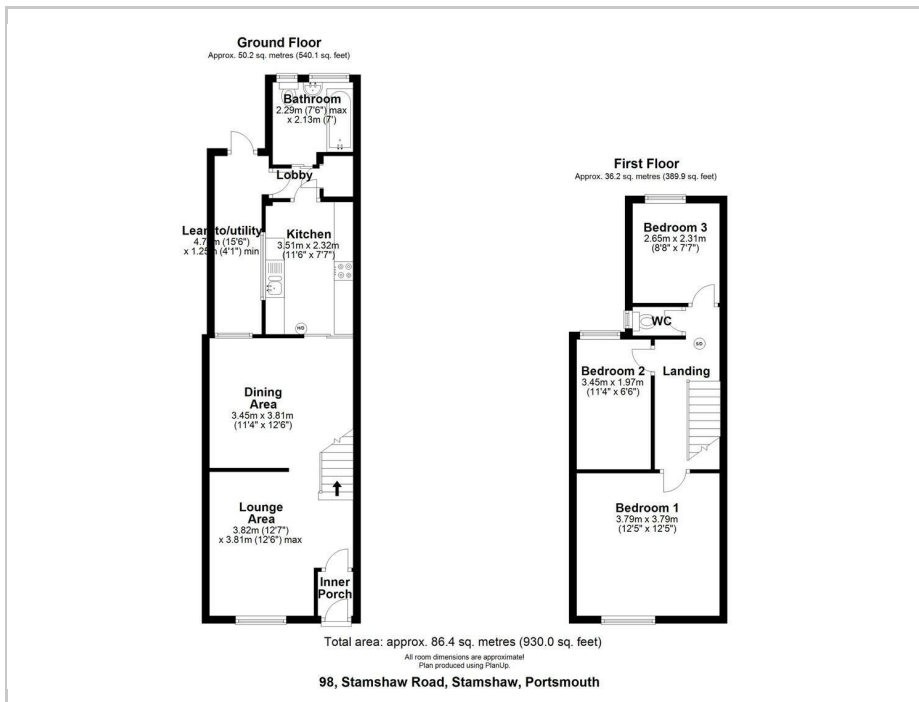

Area Map

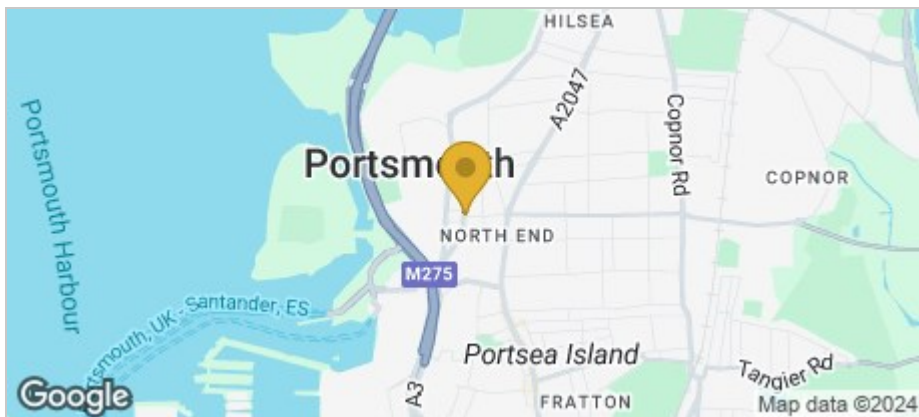

Accommodation

- Holding Deposit - £253.00
- Deposit - £1269.00
- Council Tax Band - B
- 6 Month Tenancy
- Available from 12/10/2024
- Garden
- 3 Bedrooms
- Open Plan
- Great Motorway Links
- Fitted Kitchen

Viewing

Please contact our Southsea Office on 023 9273 2241 if you wish to arrange a viewing appointment for this property or require further information.

Energy Efficiency Graph

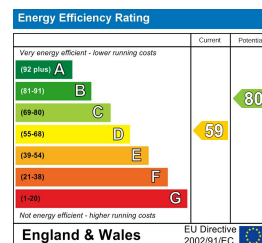

157-159 Albert Road, Southsea, Portsmouth, Hampshire, PO4 0JW
 023 9273 2241 Email: tully@tullyand.co lettings@tullyand.co

