



The Round House, Portsmouth, PO1 3SG

£725 PCM Council Tax Band A Deposit £836



**Tully's**



## Floor Plan

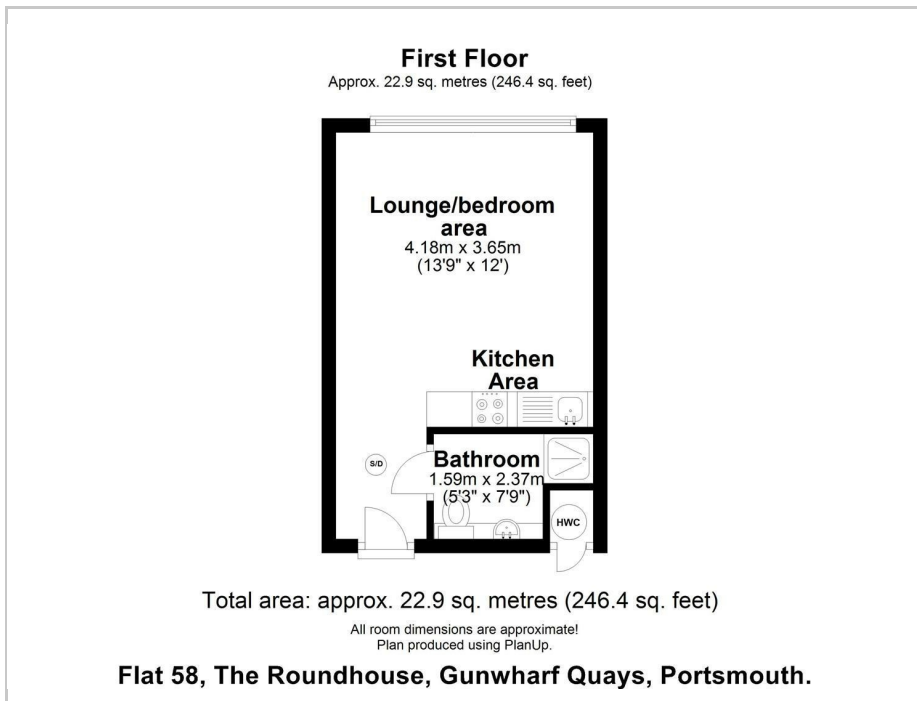

## Area Map

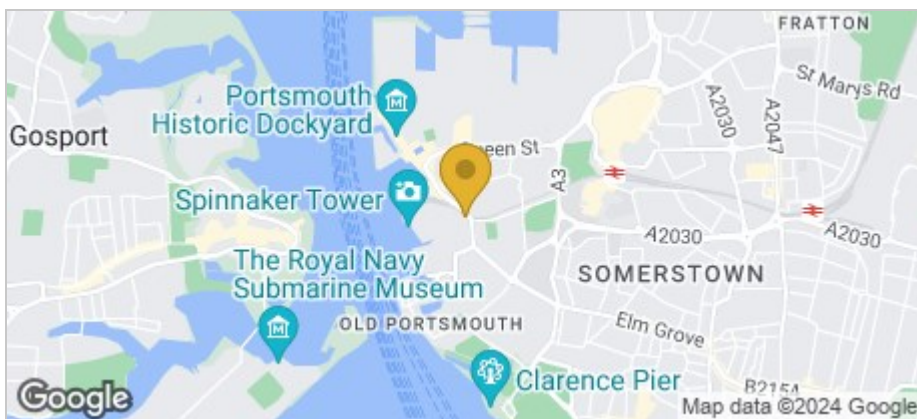

## Accommodation

- Holding deposit - £173
- Deposit - £836
- Studio
- Gun Wharf location
- Fitted Kitchen
- Shower room
- Furnished

## Viewing

Please contact our Southsea Office on 023 9273 2241 if you wish to arrange a viewing appointment for this property or require further information.

## Energy Efficiency Graph

Energy Efficiency Rating		Current	Potential
Vary energy efficient - lower running costs			
(92-100) A			
(81-91) B			
(69-80) C			
(55-68) D			
(39-54) E			
(21-38) F			
(1-20) G			
Not energy efficient - higher running costs			
England & Wales		77	80

EU Directive 2002/91/EC

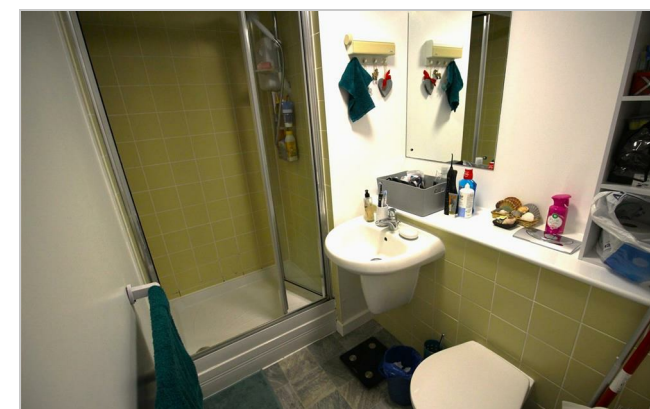

157-159 Albert Road, Southsea, Portsmouth, Hampshire, PO4 0JW  
023 9273 2241 Email: tully@tullyand.co lettings@tullyand.co

**Tully's**