



9/10 Hampshire Terrace, Portsmouth, PO1 2QF

£415 PCM Council Tax Band Deposit £478



**Tully's**

## Floor Plan

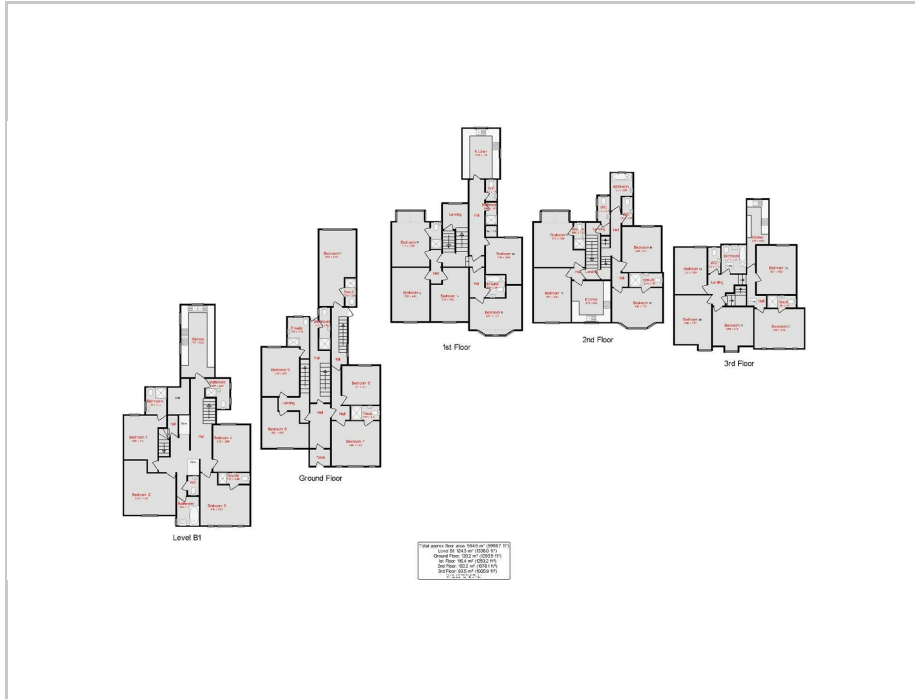

## Area Map



## Accommodation

- Rent PCM Bills Included - £415
- Deposit - £478
- Move in 01/08/2024 or 01/09/2024
- Students Only



## Viewing

Please contact our Southsea Office on 023 9273 2241 if you wish to arrange a viewing appointment for this property or require further information.

## Energy Efficiency Graph

Energy Efficiency Rating		Current	Potential
Vary energy efficient - lower running costs			
(92-100) A			
(81-91) B			
(69-80) C			
(55-68) D			
(39-54) E			
(21-38) F			
(1-20) G			
Not energy efficient - higher running costs			
England & Wales		EU Directive 2002/91/EC	

157-159 Albert Road, Southsea, Portsmouth, Hampshire, PO4 0JW  
 023 9273 2241 Email: tully@tullyand.co lettings@tullyand.co

**Tully's**