



3 St Michaels Road, Portsmouth, PO1 2EE
£575 PCM Council Tax Band Exempt Deposit £663



Tully's

Floor Plan

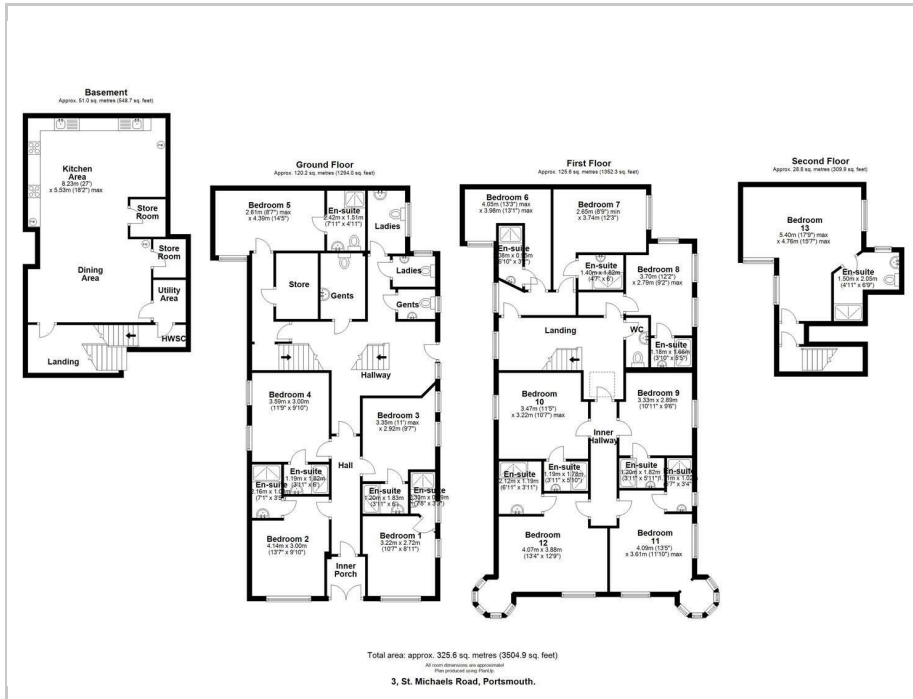

Area Map

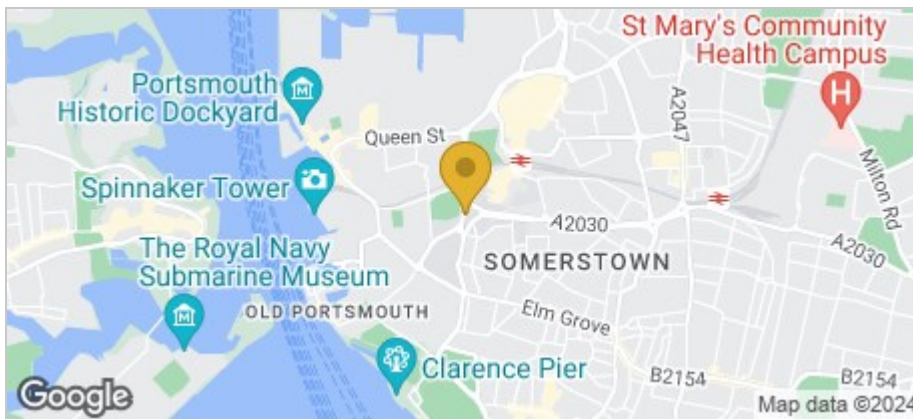

Accommodation

- STUDENTS 2024!
- Deposit - £721.00
- Rent - £625.00
- 11 Month Tenancy starting 01/09/2024
- All bills included
- fully furnished



Viewing

Please contact our Southsea Office on 023 9273 2241 if you wish to arrange a viewing appointment for this property or require further information.

Energy Efficiency Graph

Energy Efficiency Rating		Current	Potential
Vary energy efficient - lower running costs			
(92 plus)	A		
(81-91)	B		
(69-80)	C		
(55-68)	D		
(39-54)	E		
(21-38)	F		
(1-20)	G		
Not energy efficient - higher running costs			
England & Wales		EU Directive 2002/91/EC	

157-159 Albert Road, Southsea, Portsmouth, Hampshire, PO4 0JW
 023 9273 2241 Email: tully@tullyand.co lettings@tullyand.co

Tully's