



48F High Street, Portsmouth, PO6 3AG

Asking Price £110,000 Council Tax Band A Deposit



Tully's

Floor Plan

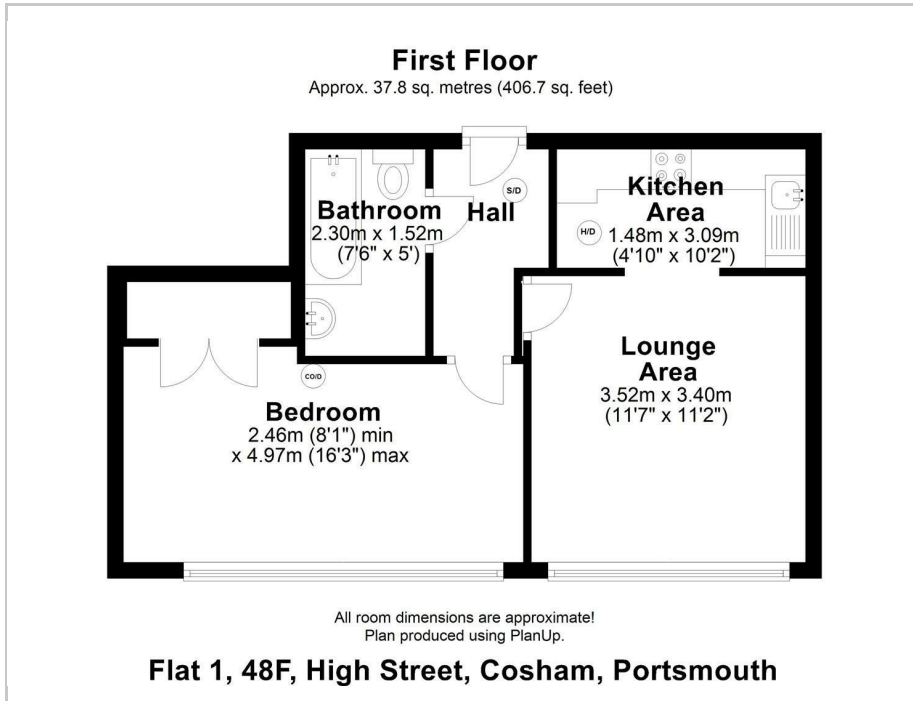

Area Map



Accommodation

- CENTRAL COSHAM LOCATION
- WALKING DISTANCE TO TRAIN STATION
- 1 BEDROOMS APARTMENT
- LARGE LOUNGE
- KITCHEN
- IDEAL FIRST TIME BUY OR INVESTMENT

Viewing

Please contact our Southsea Office on 023 9273 2241 if you wish to arrange a viewing appointment for this property or require further information.

Energy Efficiency Graph

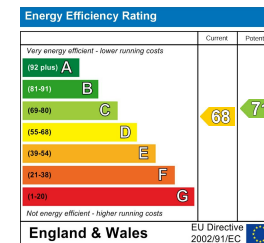

157-159 Albert Road, Southsea, Portsmouth, Hampshire, PO4 0JW
023 9273 2241 Email: tully@tullyand.co lettings@tullyand.co

Tully's