

Ashtons



329 The Residence Bishopthorpe Road YO23 1DQ

£1,100 Per Month

1



1



1



C

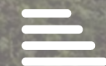

Located within the iconic building of Terry's Chocolate Factory which has been sympathetically converted into apartments is this third floor luxury one bedroom apartment. Located within walking distance of the City Centre but also the popular cafes and shops on Bishopthorpe Road, the apartment is offered for let on an unfurnished or part furnished basis. Accommodation comprises of entrance hall; open plan living kitchen equipped with electric oven, hob, integrated fridge, freezer, dishwasher, washer/dryer and microwave; double bedroom with fitted wardrobe; luxury fully tiled bathroom with shower over the bath. Large windows make this apartment light and airy.

The apartment has the added bonus of an allocated parking space, building concierge, lift access and bike storage.

Available Mid June / 6+ Month Tenancies, flexible terms available / Deposit £1200 / Council Tax Band D / Unfurnished or Part Furnished

3RD FLOOR
506 sq.ft. (47.0 sq.m.) approx.

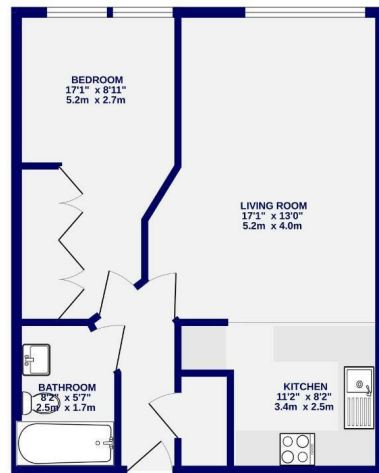

TOTAL FLOOR AREA: 506 sq. ft. (47.0 sq.m.) approx.

While every attempt has been made to ensure the accuracy of the floorplan, measurements of rooms and other areas are approximate. It is advised that the plan be measured by the purchaser. The total floor area and any discrepancy is taken for as error, omission or misstatement. This plan is for illustrative purposes only and should be used as such by any prospective purchaser. The services, systems and appliances shown have not been tested and no guarantee as to their operability.

Made with Metreco C2025



Ashtons Lettings

01904 731404

lettings@ashtonsnet.com

