



Bartlams.

22 Whites Wood, Wombourne - WV5 0JS
£475,000



22 Whites Wood

Wombourne, Wolverhampton

****NO UPWARD CHAIN**** Ideally positioned and meticulously looked after three-bedroom detached bungalow occupying a level corner plot in a popular and established residential area just off Sytch Lane, handily placed to most local amenities, picturesque greenbelt walks and Wombourne village. Whites Wood presents a well established garden wrapping from the front to the side of the property with a private drive and double-width garage.

The spacious layout of this home includes: An entrance hall to the front with built-in storage and convenient guest WC with wash hand basin; generous L-shaped lounge with space for dining and dual aspect windows allowing plenty of natural light; fitted kitchen with a range of wall and base units and a seating area for extra dining space, integrated oven and combi-oven, gas hobs and a sink with drainer; handy utility room with my worktop space and another sink with drainer for added convenience; three fantastically proportioned bedrooms all benefitting built-in wardrobe space, ideal for day to day storage; large family bathroom with a bathtub, enclosed corner shower, WC and wash hand basin; an extended double garage to the rear providing enough space for three vehicles along with an up and over door and secondary entrance from the secondary hallway off the utility; private lawned garden to the rear with patio areas to be enjoyed when soaking in the sun, the garden can be accessed from the secondary hallway or gated side-access; private drive positioned in-front of the garage allowing parking for multiple vehicles.



B.



GROUND FLOOR
1390 sq.ft. (129.1 sq.m.) approx.

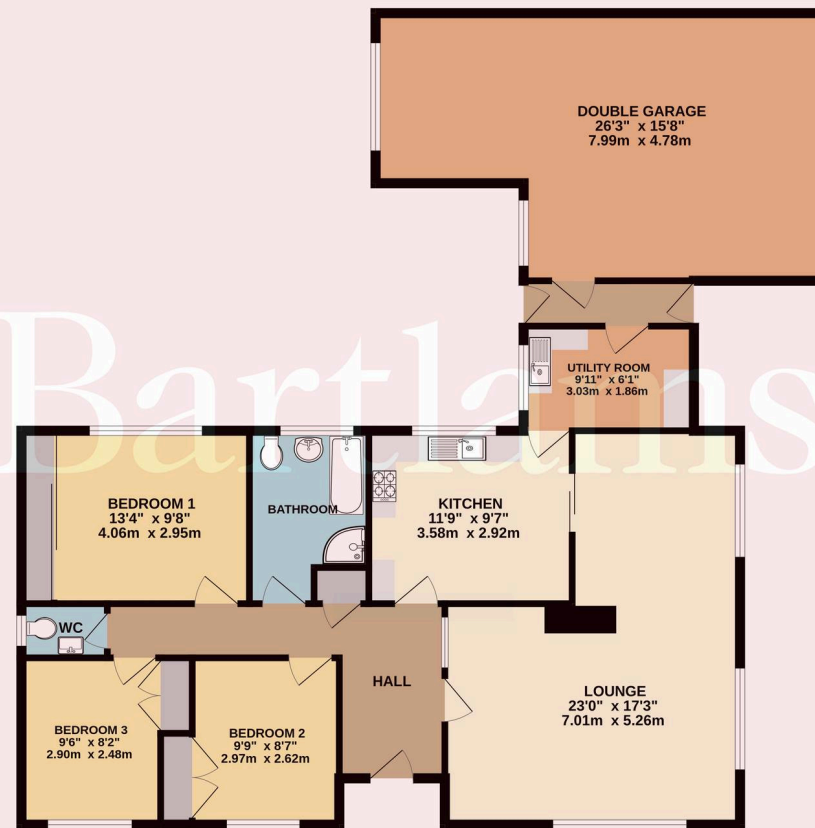

TOTAL FLOOR AREA : 1390 sq.ft. (129.1 sq.m.) approx.

Whilst every attempt has been made to ensure the accuracy of the floorplan contained here, measurements of doors, windows, rooms and any other items are approximate and no responsibility is taken for any error, omission or mis-statement. This plan is for illustrative purposes only and should be used as such by any prospective purchaser. The services, systems and appliances shown have not been tested and no guarantee as to their operability or efficiency can be given.
Made with Metropix ©2004

Bartlams

Bartlams Ltd, The House On The Green High Street - WV5 9DP

01902894141

wombourne@bartlams.co.uk

www.bartlams.co.uk/

NOTICE: These particulars, although believed to be correct, do not constitute any part of an offer or contract. All statements contained in these particulars as to this property are made without responsibility and are not to be relied upon as statements or representations of warranty whatsoever in relation to property. Any intending purchaser must satisfy themselves by inspection or otherwise as to the correctness each of the statements contained in these particulars. All measurements are approximate and for illustrative purposes only.

Photographs are produced for general information and it must not be inferred that any item shown is included in the sale. DISCLOSURE: As a professional Estate Agency our clients employ us to look after their best interests. This includes providing them with full details of offers made to purchase their property. To ensure our obligations to our clients are met we need to check the status of all potential purchasers. If you make an offer on this property we will ask a member of The Finance Family to contact you to verify your status. They are a leading firm of Independent Financial Advisers and Mortgage Brokers. Should they transact any business resulting from our introduction then we may receive a commission.

