



**Bartlams.**

---

3 Giggetty Cottages Giggetty Lane, Wombourne - WV5 0AY  
£239,950



## 3 Giggetty Cottages Giggetty Lane

Wombourne, Wolverhampton

**\*\*NO UPWARD CHAIN\*\*** Stylishly presented two-bedroom end-terraced cottage of considerable character, conveniently positioned near local and supermarket shopping, and all other usual village facilities.

The layout of this cozy two-bedroom home includes: an entrance hall with built-in storage space; lounge with feature electric fireplace with decorative surround and the stairs to the first floor; stylishly fitted kitchen with wall and base units, integrated oven with gas hobs above, and a stainless steel sink with drainer; downstairs shower room providing a bath with shower attachment, WC, and wash hand basin; two generously proportioned bedrooms, both with plenty of storage room, and the principal room benefiting from dual-aspect windows; private drive to the side offering ample parking and a gate to the rear garden; lawned garden to the rear with a large patio area and bordered by shrubs to make this outside space a private and relaxing setting to enjoy the sunshine.

We are advised by our client that this property is:  
Freehold, Council Tax Band - B, EPC - E.



B.







GROUND FLOOR  
338 sq.ft. (31.4 sq.m.) approx.

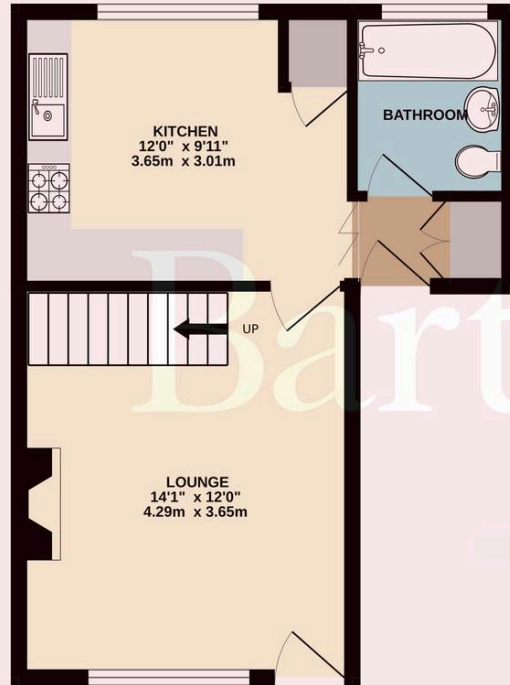

1ST FLOOR  
282 sq.ft. (26.2 sq.m.) approx.

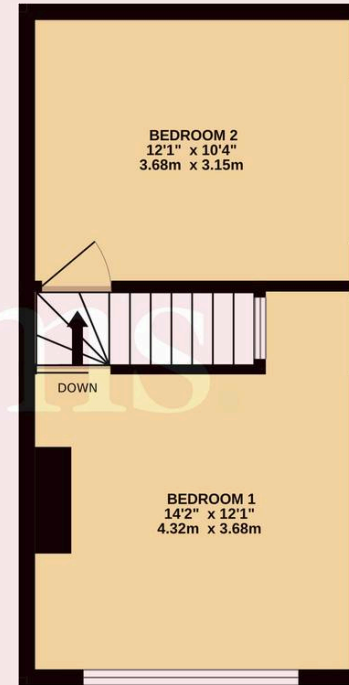

TOTAL FLOOR AREA : 620 sq.ft. (57.6 sq.m.) approx.

Whilst every attempt has been made to ensure the accuracy of the floorplan contained here, measurements of doors, windows, rooms and any other items are approximate and no responsibility is taken for any error, omission or mis-statement. This plan is for illustrative purposes only and should be used as such by any prospective purchaser. The services, systems and appliances shown have not been tested and no guarantee as to their operability or efficiency can be given.  
Made with Metropix ©2024

# Bartlams

Bartlams Ltd, The House On The Green High Street - WV5 9DP

01902 894141

wombourne@bartlams.co.uk

www.bartlams.co.uk

NOTICE: These particulars, although believed to be correct, do not constitute any part of an offer or contract. All statements contained in these particulars as to this property are made without responsibility and are not to be relied upon as statements or representations of warranty whatsoever in relation to property. Any intending purchaser must satisfy themselves by inspection or otherwise as to the correctness each of the statements contained in these particulars. All measurements are approximate and for illustrative purposes only.

Photographs are produced for general information and it must not be inferred that any item shown is included in the sale. DISCLOSURE: As a professional Estate Agency our clients employ us to look after their best interests. This includes providing them with full details of offers made to purchase their property. To ensure our obligations to our clients are met we need to check the status of all potential purchasers. If you make an offer on this property we will ask a member of The Finance Family to contact you to verify your status. They are a leading firm of Independent Financial Advisers and Mortgage Brokers. Should they transact any business resulting from our introduction then we may receive a commission.

