



Gadloch Street | | Glasgow | G22 6LT

Offers Over £85,000

**moving**

ESTATE AGENTS

## Key features

- Nicely presented main door lower cottage flat
- Convenient Location in popular Parkhouse area
- Large lounge with triple bay window with open aspect to front garden
- Two double bedrooms
- Newly landscaped front garden
- Gas Central Heating
- Double Glazing
- Council Tax Band D

## Description

Very nicely presented lower cottage flat offering generously proportioned accommodation set back from the road in the popular residential area of Parkhouse.

The property is further enhanced by gas central heating, new carpets and modern décor throughout. The property also benefits from a large private sunny front garden which has been recently landscaped with slabbed area and artificial grass.

This flat is an excellent first-time buyer property and early viewing is highly recommended.

## Directions



Very nicely presented lower cottage flat offering generously proportioned accommodation set back from the road in the popular residential area of Parkhouse.

The property is further enhanced by gas central heating, new carpets and modern décor throughout. The property also benefits from a large private sunny front garden which has been recently landscaped with slabbed area and artificial grass.

This flat is an excellent first-time buyer property and early viewing is highly recommended.



# Floor plans

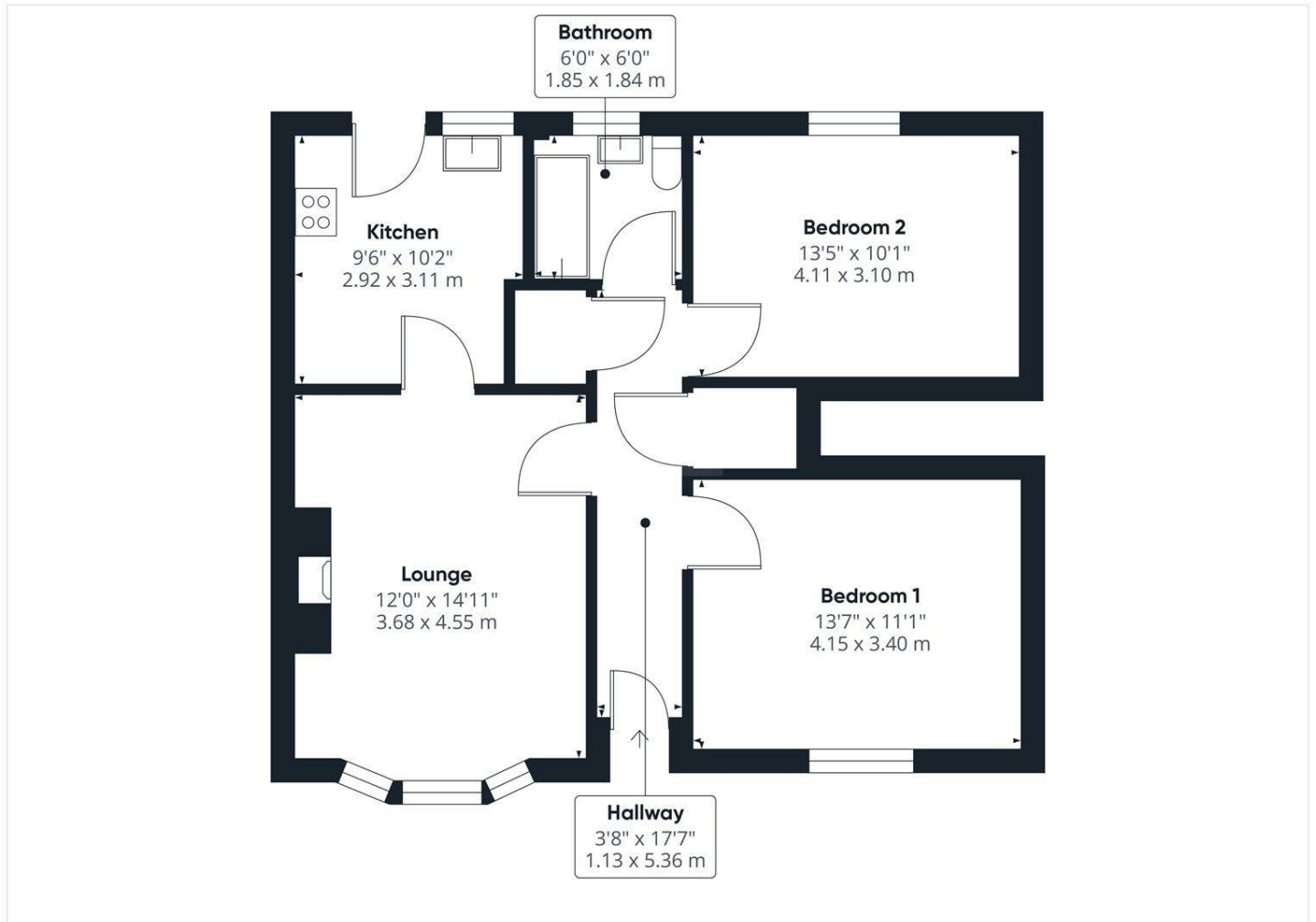

Energy Efficiency Rating		
	Current	Potential
<i>Very energy efficient - lower running costs</i>		
(92 plus) <b>A</b>		
(81-91) <b>B</b>		
(69-80) <b>C</b>	73	78
(55-68) <b>D</b>		
(39-54) <b>E</b>		
(21-38) <b>F</b>		
(1-20) <b>G</b>		
<i>Not energy efficient - higher running costs</i>		
<b>Scotland</b>	EU Directive 2002/91/EC 	

**moving**

ESTATE AGENTS

127 Byres Road

Glasgow

G12 8TT

0141 334 7000

reception@movingwestend.co.uk

movingwestend.co.uk