

Kings Chase, East Molesey, KT8 9DG



£325,000 Leasehold - Share of Freehold

Harmes Turner Brown are pleased to offer this two bedroom ground floor maisonette which is situated in a cul de sac on a highly regarded development in East Molesey, within a short distance of Hurst Meadow and the River Thames and approximately 0.83 miles to Hampton Court with its mainline station to London Waterloo. The property briefly comprises:- entrance lobby, living room, separate shaker style kitchen with fitted oven, hob and dishwasher, two double bedrooms and a generous size bathroom. Externally there is a small open plan garden to the front and an allocated parking space. Other features include gas central heating via radiators and double glazing throughout. 995 years unexpired lease, equal share of freehold. Council tax band C. No onward chain. Please contact our East Molesey office on 0208 001 8385 to arrange a viewing.

Kings Chase, East Molesey, KT8 9DG

Ground Floor

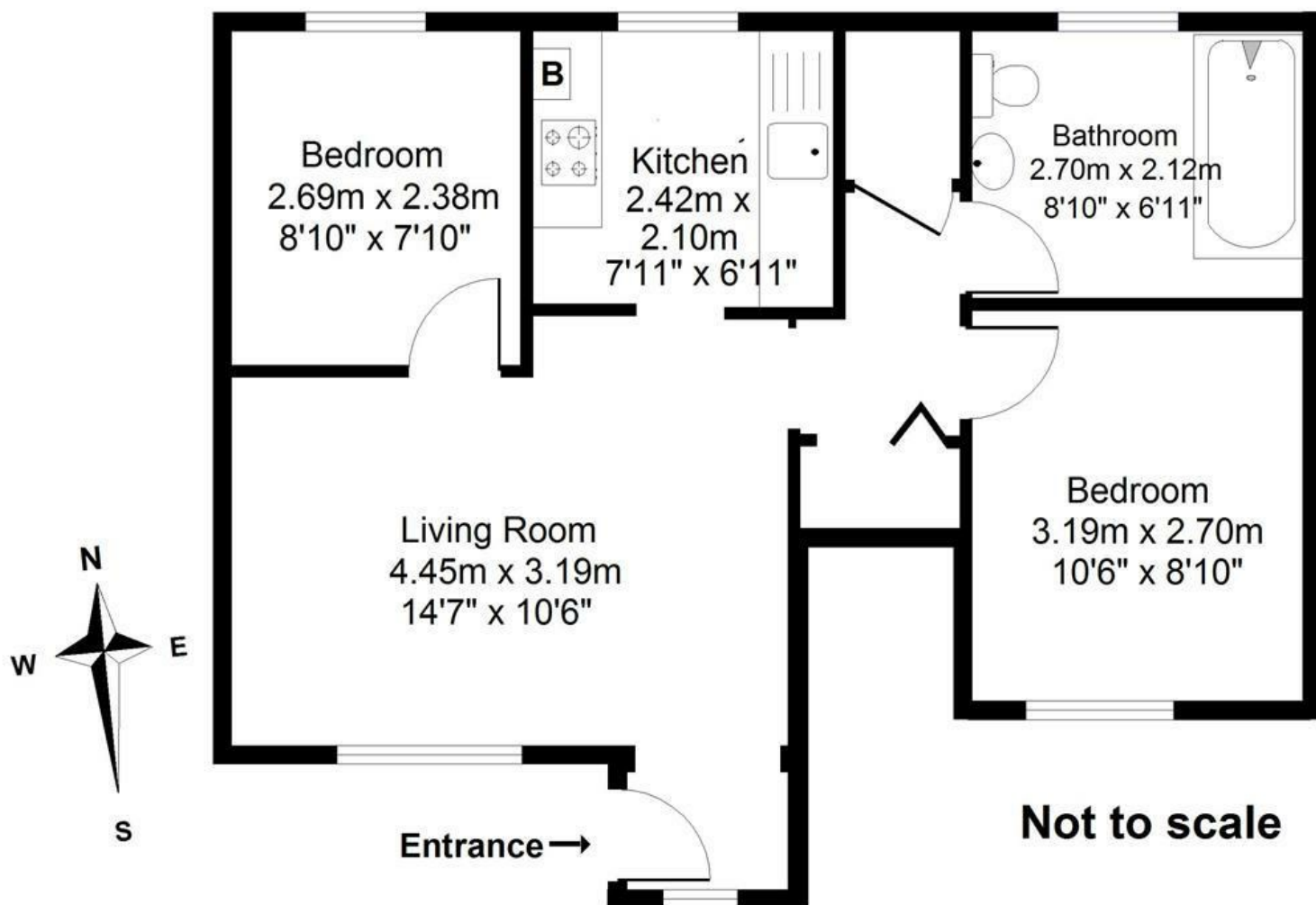

Approximate Gross Internal Floor Area:
46.9m sq (504sq ft)

Whilst every attempt has been made to ensure the accuracy of the floor plan contained here, measurements of doors, windows and rooms are approximate and no responsibility is taken for any error, omission or misstatement. These plans are for representation purposes only as defined by RICS Code of Measuring Practice and should be used as such by any prospective purchaser. Specifically no guarantee is given on total square footage of the property if quoted on this plan. Any figure given is for initial guidance and should not be relied on as a basis of valuation.

- TWO DOUBLE BEDROOMS
- GAS CENTRAL HEATING
- UNDER A MILE TO HAMPTON COURT MAIN LINE STATION
- CUL DE SAC LOCATION
- DOUBLE GLAZING
- CLOSE TO THE RIVER THAMES
- ALLOCATED PARKING SPACE
- NO ONWARD CHAIN

This plan is a representation of the property and measurements, where given, are approximate. None of the fixtures and fittings have been tested by us. These details are thought to be materially correct but we cannot guarantee there are no error and emissions and they do not form part of any contract

