



21 Saint Mary's Terrace
East Wemyss
Kirkcaldy, Fife
KY1 4LG



2



2



1

Please contact us for
more information:

0131 555 7055
property@watermans.co.uk



Summary

Enjoying a quiet position within an established residential area of East Wemyss on the picturesque Fife coast, this two-bedroom mid-terraced cottage offers bright and spacious interiors, with neutral décor, some modern touches, and characterful features. The home benefits from open green space adjacent to the rear, as well lying within easy reach of village amenities and close to more extensive facilities and services in the surrounding towns, including Kirkcaldy which is just under six miles away.

Features

- Traditional mid-terraced cottage in East Wemyss
- Well-presented interiors and neutral décor
- Welcoming entrance hallway
- West-facing living room with fireplace
- Airy kitchen with garden access
- Versatile dining room
- Two double bedrooms, one with a built-in wardrobe and the other with a dressing room/study
- Bright, modern shower room with rainfall showerhead
- Low-maintenance rear garden with gated access to green space adjacent
- Front garden and private driveway
- Gas central heating and double glazing



Floorplan

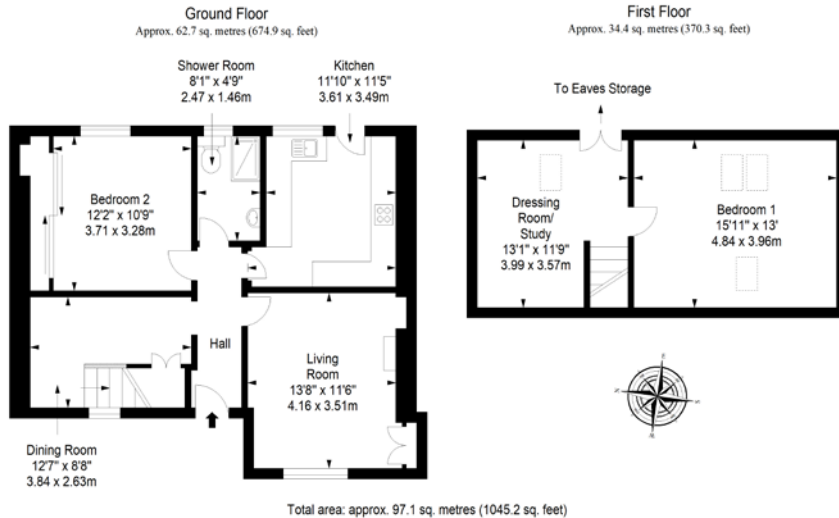

Price & Viewings

Please refer to our website
www.watermans.co.uk

Edinburgh

5-10 Dock Place, Leith, EH6 6LU
0131 555 7055
property@watermans.co.uk

Glasgow

193 Bath Street, Glasgow, G2 4HU
0141 483 8325
westcoast@watermans.co.uk

EPC Rating - D | Council tax band - C | Home report Value - £180,000

Extras: All fitted floor coverings, window coverings, light fittings, and integrated kitchen appliances will be included in the sale.