



84 Bellevue Road
Bellevue, Edinburgh
EH7 4DE



Please contact us for
more information:

0131 555 7055
property@watermans.co.uk



Summary

Representing an ideal home for first-time buyers, professionals, couples, small families, and rental investors alike, this semi-detached house in Bellevue is well-presented with attractive, modern interiors and a tasteful palette of décor. The home is tucked in a cul-de-sac and comes accompanied by a low-maintenance garden and a private driveway. It also lies close to excellent amenities, such as shops, schools (both catchment schools are a few minutes' walk away), transport links, and a wealth of green space.



Features

- Semi-detached house in Bellevue
- Well-presented, modern interiors
- Welcoming entrance hallway
- Elegant living room with beautiful fireplace
- Attractive dining kitchen with garden access
- Two well-proportioned bedrooms (one with built-in wardrobes)
- Stylish bathroom with shower-over-bath
- Beautifully landscaped rear garden
- Private front driveway
- Gas central heating and double glazing



SMEG









Floorplan

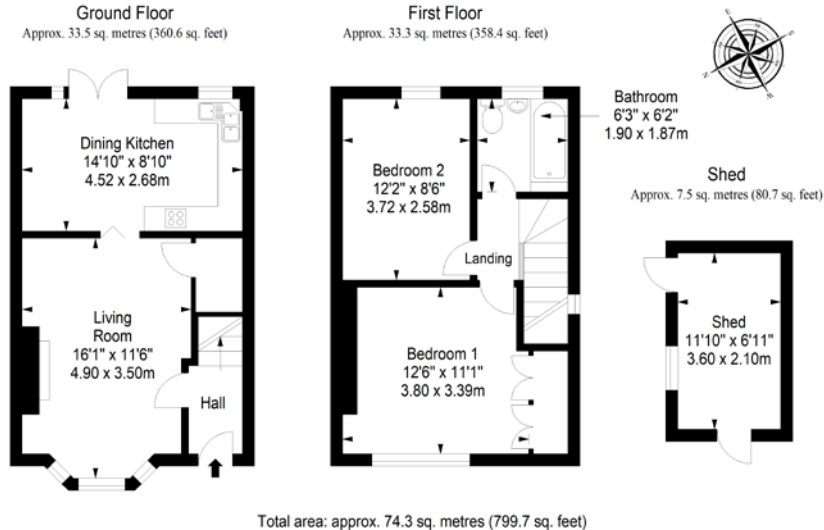

Price & Viewings

Please refer to our website
www.watermans.co.uk

Edinburgh

5-10 Dock Place, Leith, EH6 6LU
0131 555 7055
property@watermans.co.uk

Glasgow

193 Bath Street, Glasgow, G2 4HU
0141 483 8325
property@watermans.co.uk

EPC Rating - C | Council Tax band - D | Home Report value - £400,000

Extras: All fitted floor coverings, window coverings, light fittings, and integrated kitchen appliances will be included in the sale.

ēspc rightmove  Zoopla.co.uk

These particulars do not constitute part of an offer or contract. All statements contained herein whilst believed to be correct are in no way guaranteed. Intending purchasers should satisfy themselves by inspection or otherwise as to the correctness of each of the statements contained in these particulars. Prospective purchasers are advised to have their interest noted through their solicitor as soon as possible in order that they may be informed in the event of an early closing date being set for the receipt of offers.