



Alscot Road, SE1

£340,000

A highly attractive Ground Floor Flat in a unique 1920s Art Deco Conversion with an open plan kitchen and living room, a three piece bathroom and a generous double bedroom, plus ample storage and access to a large, rooftop communal terrace. Sold chain free.

Solarium Court enjoys an enviable location, moments from Bermondsey Spa Gardens and the vibrant Bermondsey Street, renowned for its independent cafés, boutique shops and restaurants. The celebrated Maltby Street Market and Borough Market are also close by, offering some of London's finest food and produce. There are excellent transport links via London Bridge and Bermondsey Stations.

Features

- Extended Lease (On Completion)
- Art Deco
- One Double Bedroom
- Communal Terrace
- Very Centrally Located
- Excellent Transport Links
- Chain Free Sale

Alscot Road,
London, SE1

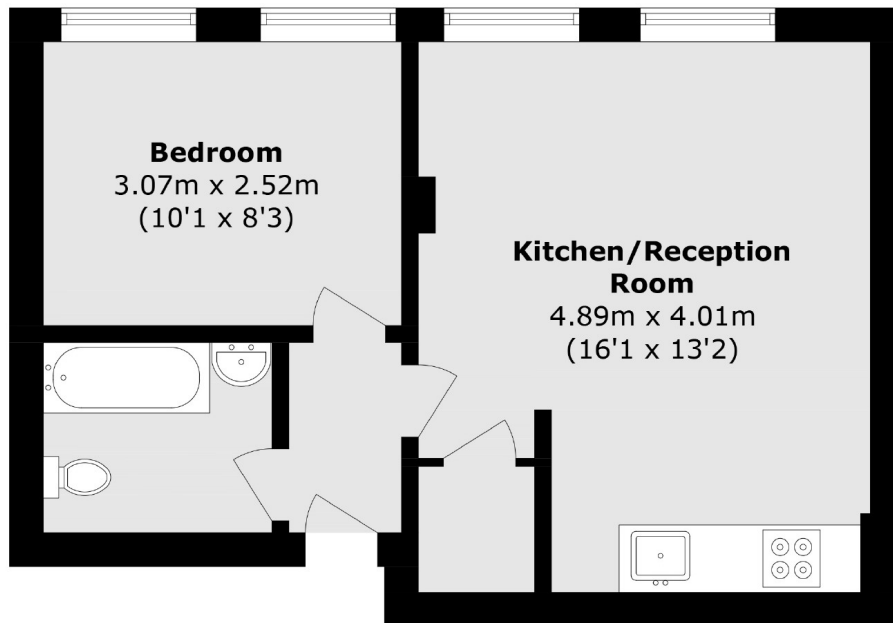

Total area (approx.): 34.1 sq. m (367 sq. ft)

Dexters

London Bridge
54 Borough High Street
London
SE1 1XL
Sales
020 7650 5 100

Energy Rating: . We aim to make our particulars both accurate and reliable. However they are not guaranteed; nor do they form part of an offer or contract. If you require clarification on any points then please contact us, especially if you're traveling some distance to view. Please note that appliances and heating systems have not been tested and therefore no warranties can be given as to their good working order.

 **RICS** | Regulated
Estate Agent
and Letting Agent

dexters.co.uk